

Eco Metal Garden Shed

OWNER'S MANUAL / Instructions for Assembly Size 8 Ft. x 6 Ft./ 2.6m x 1.8m

Ver: 0.0



ISO 9001:2008

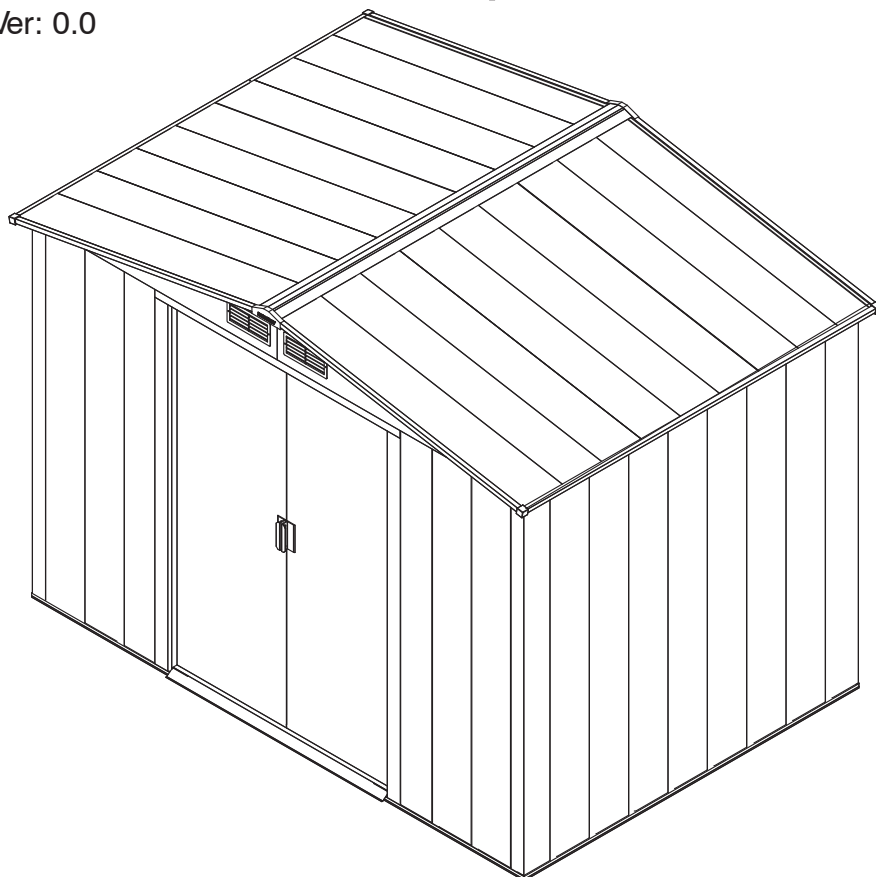

**Customer
Service Hotline
(800) 483-4674**
www.duramaxbp.com

- Tall Walk in Shed
- Quick & Easy Assembly
- Ridge Reinforced Walls
- Wide Double Doors
- Available in Various Sizes

Call us for any missing or damaged parts.
Do not return to the store.

Building Dimensions :

Building Dimensions :											
Approximate Size	Storage		Exterior Dimension				Interior Dimension		Door Opening		
	Area	Volume	Base Dimension		Roof Edge to Edge		Wall to Wall				
8 Ft x 6 Ft	43 1/8 Sq. Ft	236 Cu.Ft	inch		cm	inch	cm	inch	cm	inch	cm
			Width	99 1/4	252	103 1/8	262	97 1/2	247.8	39 3/4	101
2.6 m x 1.8 m	4.0 Sq.m	6.7 Cu.m	Depth	67 3/4	172	71 3/4	182.2	63 8/9	162.3		
			Height			75 1/8	191	65 1/2	166.4	63	160

Duramax Storage Shed Limited Eight Year Warranty

U.S. Polymer Inc. will send a replacement part free of charge, in the event of material defects and or workmanship for a period of eight Years from the date of purchase.

This warranty is extended only to the original purchaser. A purchase receipt or other proof of date of original purchase will be required before warranty service is rendered. In no event shall we pay the cost of flooring, labor, installation or any other costs related thereto.

This warranty only covers failures due to defects in material or workmanship which occurs during normal use and does not extend to color change arising due to normal weathering or to damage resulting from misuse or neglect, commercial use, failure to follow assembly instructions and the owner's manual (including proper anchoring of the shed), painting, forces of nature and other causes which is beyond our control.

Claims under this warranty must be made within the warranty period by calling 1-800-483-4674 or mail in a dated sales slip and clear photograph of the part to:

U.S. Polymers Inc.
1057 S. Vail Ave,
Montebello, CA 90640.

We reserve the right to discontinue or change components. If a component has been discontinued or is not available, U.S. Polymers, Inc. reserves the right to substitute a component of equal quality as may be compatible

Limits and Exclusions

There are no express warranties except as listed above. The warrantor shall not be liable for incidental or consequential damages resulting from the use of this product, or arising out of any breach of this warranty. All express warranties are limited to the warranty period set forth above. Some states do not allow the exclusion or limitation on how long an implied warranty lasts, so the above limitations may not apply to you.

This warranty gives you specific legal rights and you may also have other rights which vary from state to state or country to country.

SAFETY & PRECAUTIONS

For your own safety, please read and follow these instructions during the shed assembly.

Before You Begin...

1. Check your local building codes regarding footings, location, etc.
2. Select a site that allows enough working space around the shed.
3. Determine building foundation and anchor system.
4. Read and understand the Owner's manual enclosed in the package.
5. Follow all directions and dimensions thoroughly.
6. Follow the steps given in the manual carefully for correct assembly.
7. Make sure all parts are present before you start assembling.
8. **BE SAFE** : Follow safety instructions and avoid injury.
(See inside page).
9. **GROUND MUST BE EVEN** : Make sure the foundation frame lies flat on the ground. If the earth bed is uneven, remove sod and other debris and level it with a flat shovel.
10. Separate contents of the carton by the part number and review the list. Be sure you have all the necessary parts for your shed. Refer Owner's manual for part list.





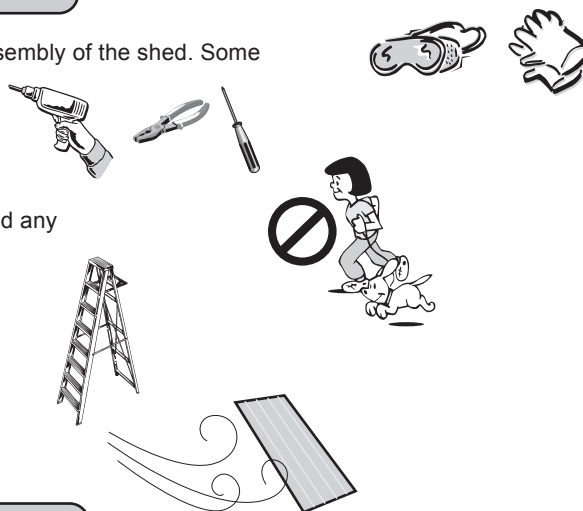

Safety First !

1. Always wear work gloves, long sleeves and eye protection during assembly of the shed. Some pieces of the shed contain sharp edges and can cause injury.
2. Be cautious with the tools used for the assembly of the shed. Familiarize yourself with the operation of all the power tools.
3. Children and pets should be kept away from the assembly site to avoid any distractions and accidents.
4. When using a step ladder, make sure it is on even ground and fully open with the safety latch in place. Never concentrate your full weight on the roof or any part of the shed.
5. Do not attempt to assemble the shed on a windy day. Shed panels can be whipped across by the wind making the worksite difficult and dangerous.



Important

-  Wear eye protection when using any form of power tools. Do not use voltage power tools in a wet or damp environment to avoid electric shock.
-  Do not use any part of the shed as a means of personal support while attaching components during assembly.
-  **The shed must be constructed on a solid base foundation.** A concrete pad or a large size concrete patio stone squares is recommended for suitable floor base. Make sure it is firm and level and will allow drainage away from the site. The base foundation should be at least 4 inches (100mm) larger than the shed dimensions. Please refer to the front page of your owner's manual for the exterior dimensions of the shed. **Manufacturer is not responsible for the choice and construction of the foundation.**
For a concrete pad base, prepare a level bed for a firm footing layer of crushed stone. The concrete pad should then be poured to a thickness of 4 inches (100mm) to 5 inches (125mm). Allow to dry thoroughly for at least 48 hours.
-  Your shed must be firmly anchored to the concrete pad or large concrete patio stone squares, to help protect against damage in high winds.

Care & Maintenance

Although this unit does not require any maintenance, care should be taken to prolong the life of your shed.

ROOF : Keep roof clean of leaves and snow with long handled, soft bristled broom. Heavy amounts of snow on the roof can damage the shed making it unsafe. Do not step on the roof.

WALLS : Do not rest any object against the wall panels of the shed.

DOORS : Keep doors closed to prevent wind damage.

FASTENERS : Regularly check your shed for loose screws, bolts, nuts, etc. And retighten them as necessary.

MOISTURE : With changing temperatures, condensation will accumulate inside the shed. Good ventilation will help in regulating and avoid moisture.

TIP : A noncorrosive caulking is helpful to seal the shed.



**DO NOT store swimming pool chemicals in your building.
Combustibles and corrosive must be stored in
air tight containers**



Parts List

Note: Check all parts prior to installation.

CODE	QTY	CODE	QTY
BLB	1	RF4B	2
BRB	1	RFCH	2
BSB	2	TSLB	1
BBF	2	TSRB	1
ECG	1	BSLB	1
DCL	1	BSRB	1
DCR	1	DSS	2
ABLB	1	DSCB	4
ABRB	1	WCFE	2
ASH	2	WCBE	2
SCB	1	WSE	6
SSB	1	WFE	2
SLB	1	GPLG	2
SRB	1	GPRG	2
RSH	7	GPVG	2
RS1H	1	GPS	2
SB1G	2	RPE1G	2
SB2G	2	RPE2G	2
SBE1G	4	RPE3G	2
SBE2G	4	DPLB	1
SBE3G	8	DPRB	1
RF1G	2		
RF2G	2		
RF3B	2		

ACCESSORIES

CODE	QTY
BS	4
DH	2
FC	2
TC	4
TS	4
VC	4
PW	3 Slabs
PC	3 Slabs
WST	2.8 mtrs
S1	247
S2	26
S3	103

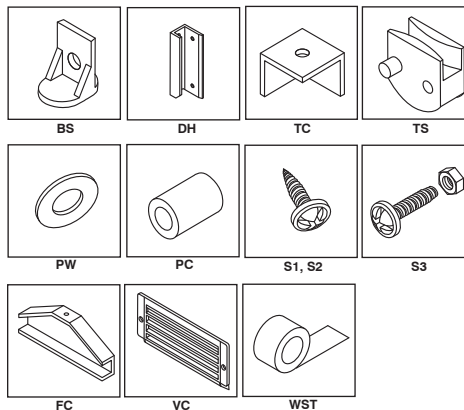

Note

Use screws with plastic washers on top of pre-painted surface only. Before starting installation, please refer Safety & Precautions.

Tools You Will Need

Hand Gloves
Cordless Drill - Philips Head
Screw driver - Philips Head
Carpenter's Square
Eye Protector

8' Step Ladder
Adjustable pliers
Level - 3ft.
Tape Measure

PROFILES

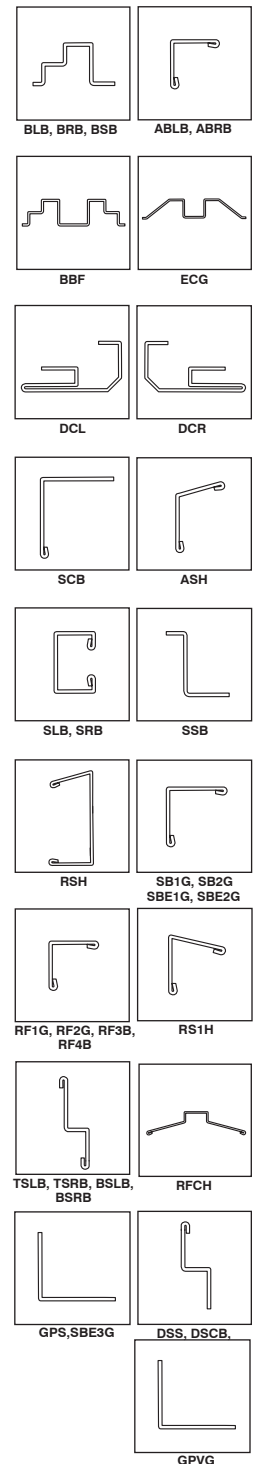



A. Foundation

Note : 1. If you have DURAMAX Foundation, please follow instruction manual in that package.
2. If you need to build platform yourself, please follow below foundation instructions.

DuraMax must be installed on a level wooden platform or a level concrete foundation.

Use pressure treated wood studs 2 x 4 (Actual size 2"x 3 1/2", 50mm x 88.9mm) to create a platform frame that has an outside dimension of 70" x 100 1/2" (1778mm x 2552.7mm).

Using exterior grade CDX 3/4" (19mm) plywood, cut and fit together the sheets to form solid foundation as shown. Foundation must be square and level.

Note

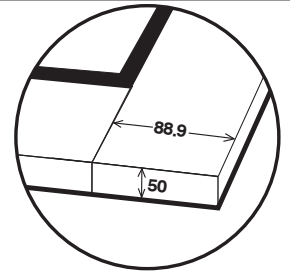

Lay 2 x 4 Flat
(Actual size 2"x 3 1/2", 50mm x 88.9mm)

Wooden Platform (Not Included)

The following are the list of lumber and sizes you will need.

Pressure Treated - Wood Studs:

4ea 2" x 3 1/2" x 90" (50mm x 88.9mm x 2286 mm)
3ea 2" x 3 1/2" x 70" (50mm x 88.9mm x 1778 mm)

Exterior Grade (CDX) - 3/4" (19mm) plywood

1ea 3/4" x 48" x 96" (19mm x 1219.2mm x 2438.4mm)
1ea 3/4" x 22" x 96" (19mm x 558.8mm x 2438.4mm)
1ea 3/4" x 4 1/2" x 70" (19mm x 114.3mm x 1778mm)

L-Brackets: 4ea

L-BRACKET

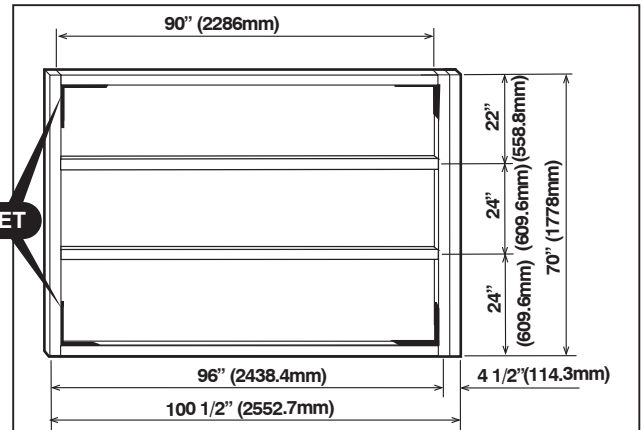

Note



If the shed is assembled with wooden foundation on soil, use the soil anchor kit.

Concrete Platform

The shed must be constructed on a solid base foundation. A concrete pad or a large size concrete patio stone squares is recommended for suitable floor base. Make sure it is firm and level and will allow drainage away from the site. The base foundation should be at least 4 inches (100mm) larger than the shed dimensions. Please refer to the front page of your owner's manual for the exterior dimensions of the shed. **Manufacturer is not responsible for the choice and construction of the foundation.**

Note



For a concrete pad base, prepare a level bed for a firm footing layer of crushed stone. The concrete pad should then be poured to a thickness of 4 inches (100mm) to 5 inches (125mm). Allow to dry thoroughly for at least 48 hours.

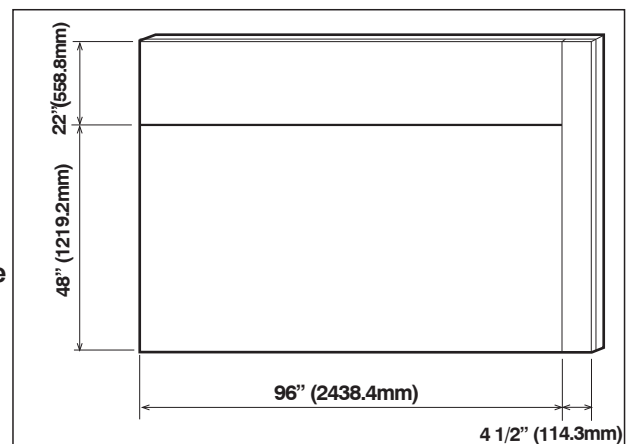

B. Base Frame

Parts needed

CODE	QTY
BLB	1
BRB	1
BSB	2
BBF	2
ECG	1
S1	12
S2	22

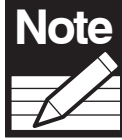

Note It is important that these instructions are followed step by step. Don't install under windy conditions. Use screws with plastic washers on top of prepainted surface only. Take care of sharp edges.

Set the Torque limit of your Screw drill to #3 or #4 to ensure the Screws do not strip the Metal reinforcements.

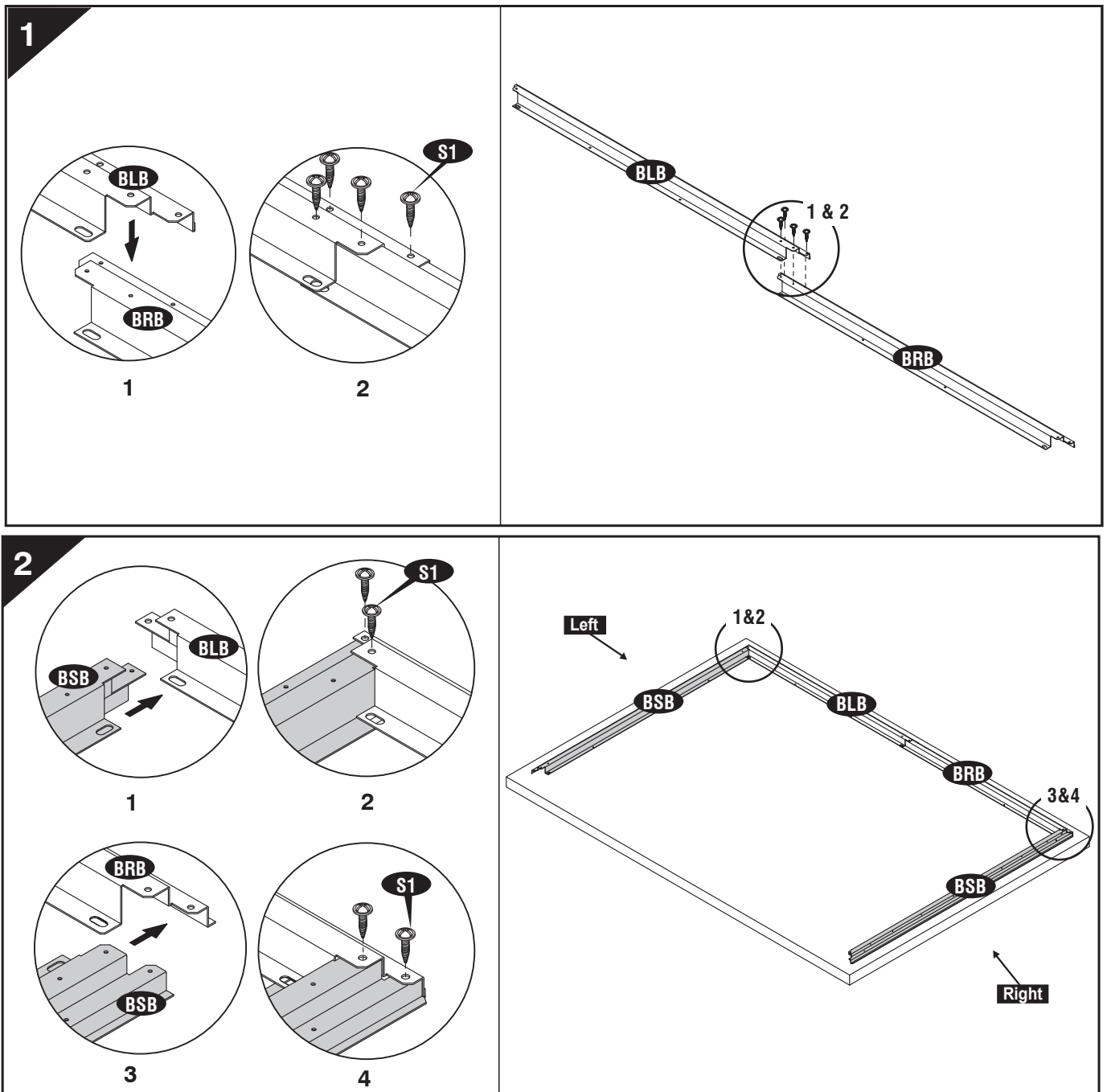

3

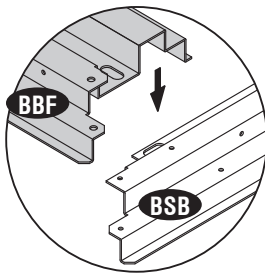

1

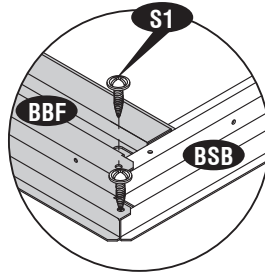

2

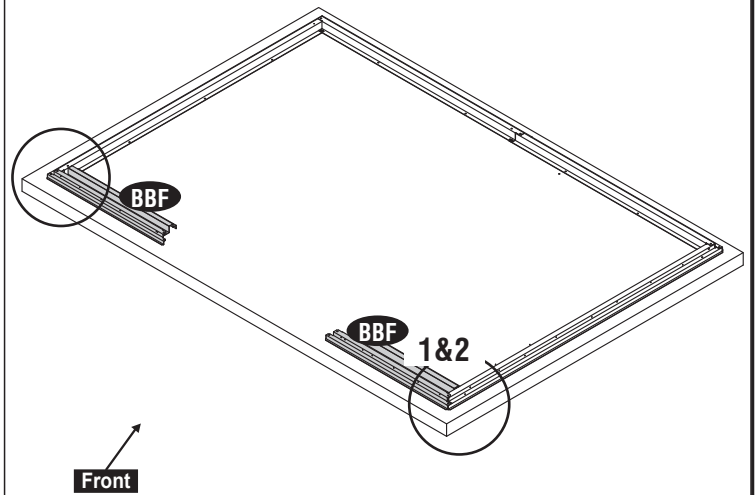

4

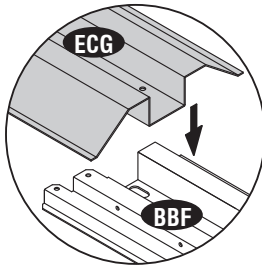

1

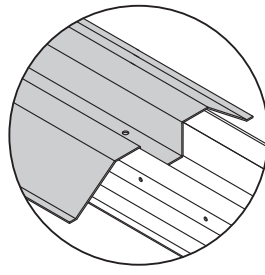

2

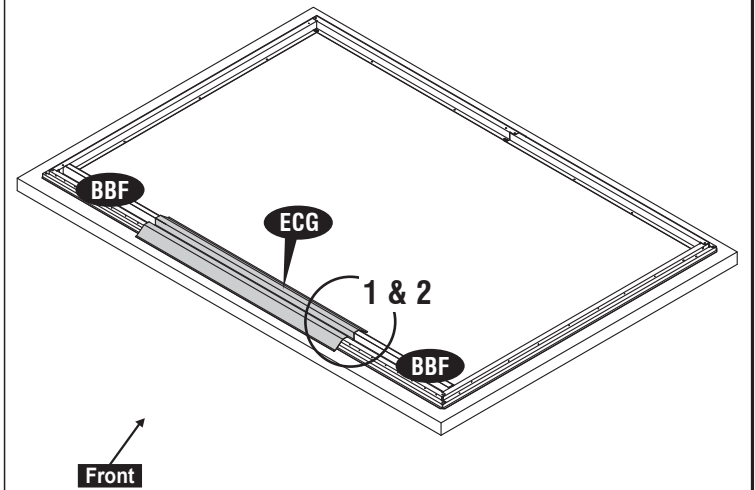

5



Measure in all direction as shown in figure.
Make the base bar assembly in a perfect square.

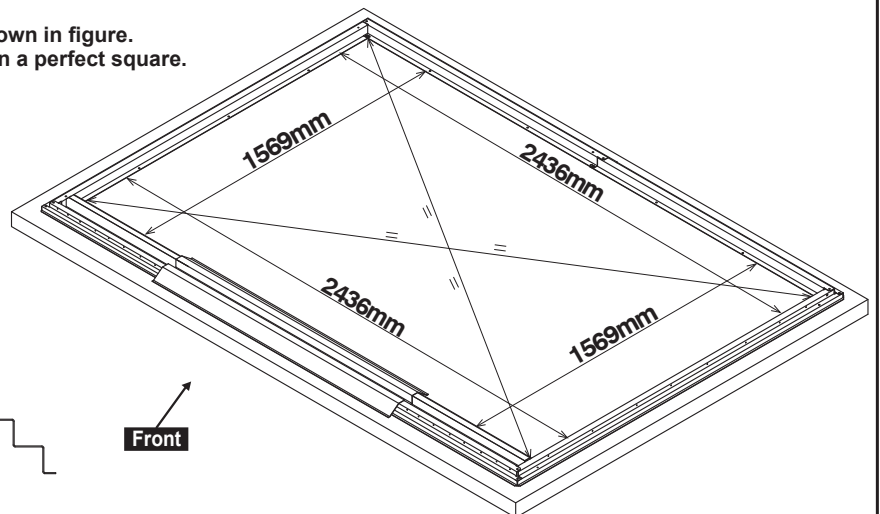

Front

6

IMPORTANT: USE HAND GLOVES TO PREVENT INJURY.

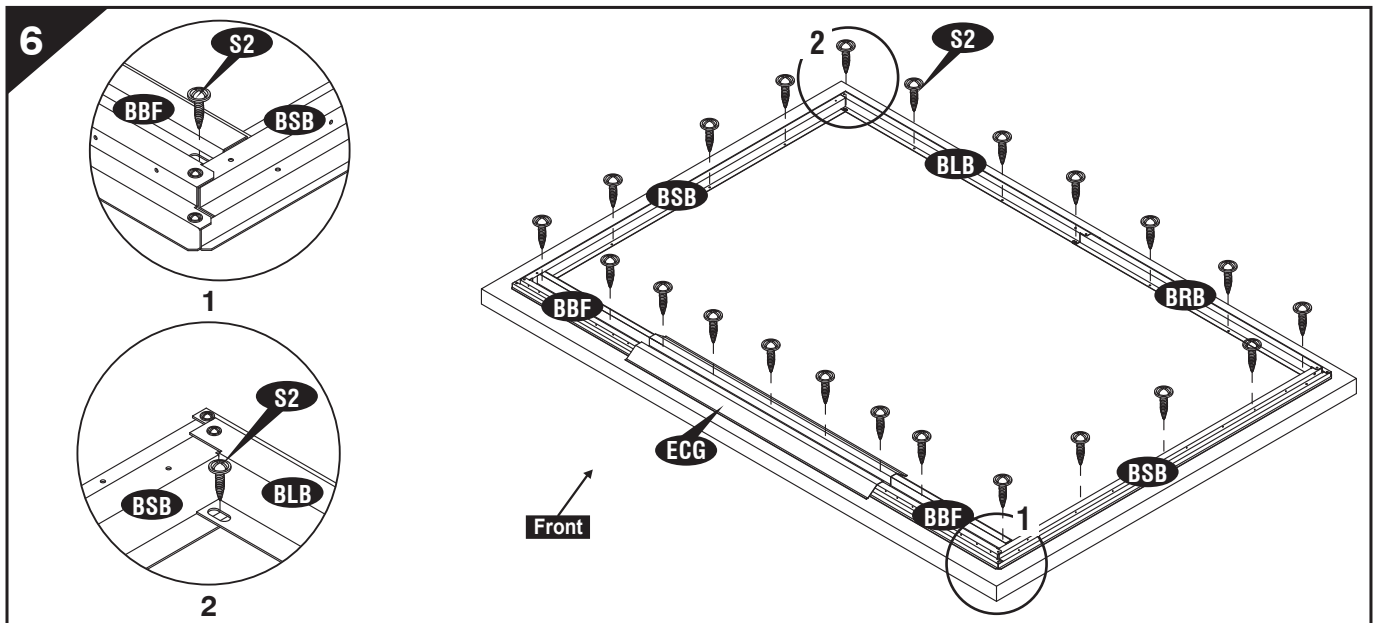

Assembly on concrete foundation

Shed or shed foundation should be placed on concrete footing by use of anchor bolt. Using a carpenter square, line up corners. Align base bars, mark the concrete at the holes in the base and drill concrete with suitable concrete bit to accept 3/16" x 1 1/2" (M5 x 40mm) anchor bolts. (not provided).

C. Walls & Columns

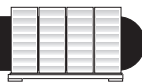

CODE	QTY	CODE	QTY
WFE	2	SCB	1
WCFE	2	TS	4
WCBE	2	DCL	1
WSE	6	DCR	1
SRB	1	ABLB	1
SLB	1	ABRB	1
ASH	2	PW	85
SSB	1	S1	90
		S3	11



Note All parts are clearly marked and care should be taken to use the correct one.

IMPORTANT :

Use screws with plastic washers on top of prepainted surface only.

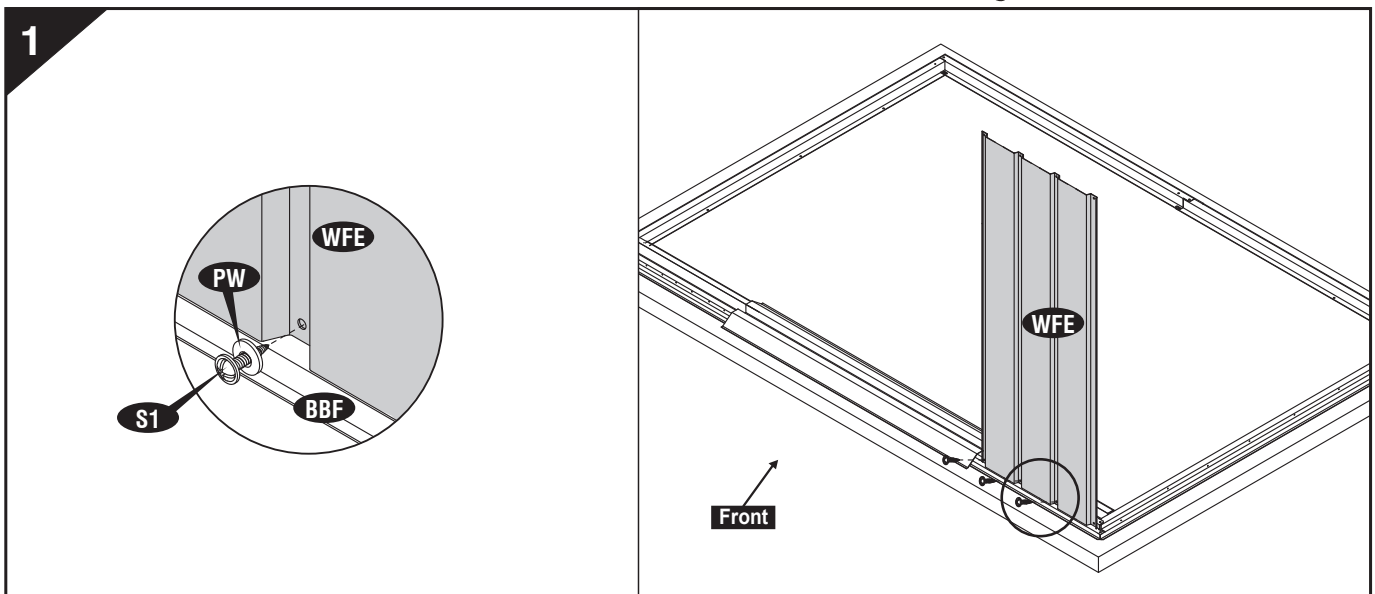
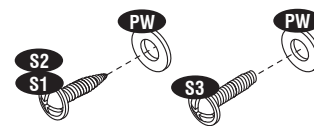

2



Note Make sure the overlapping position is as shown in fig.1.

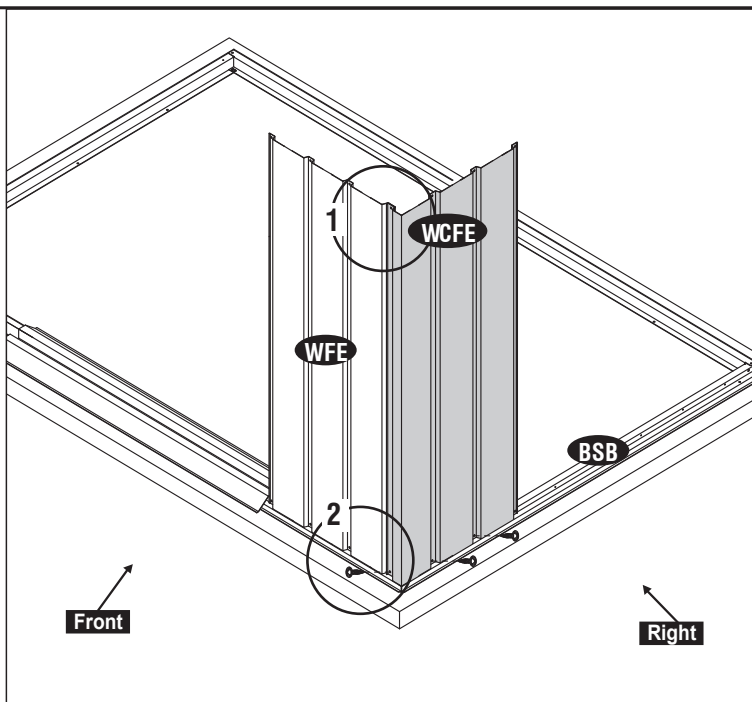
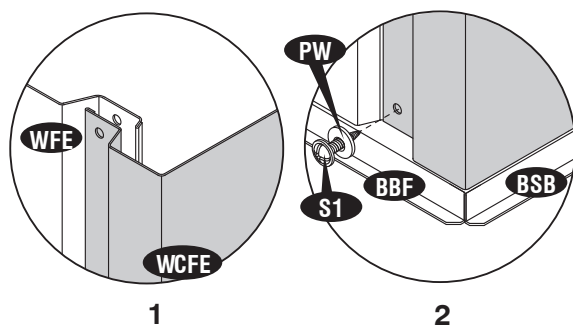

3

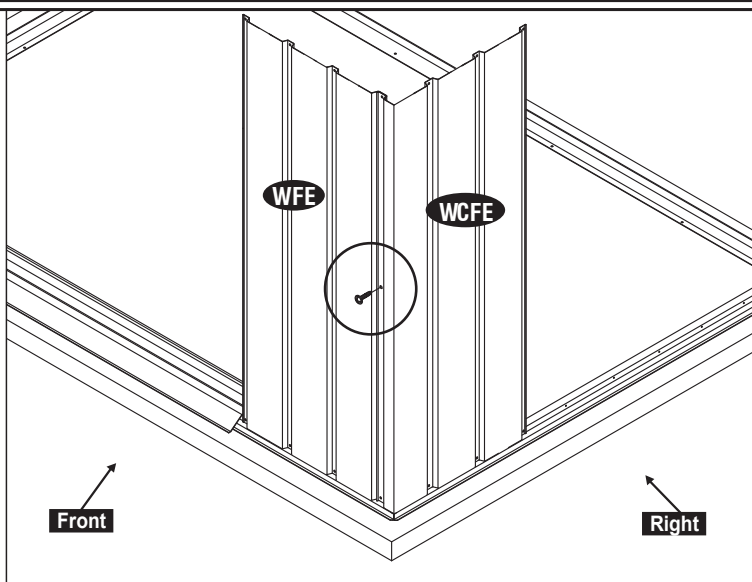
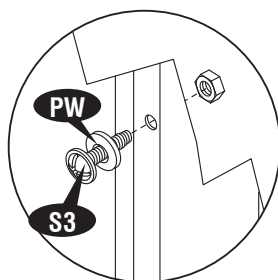

4

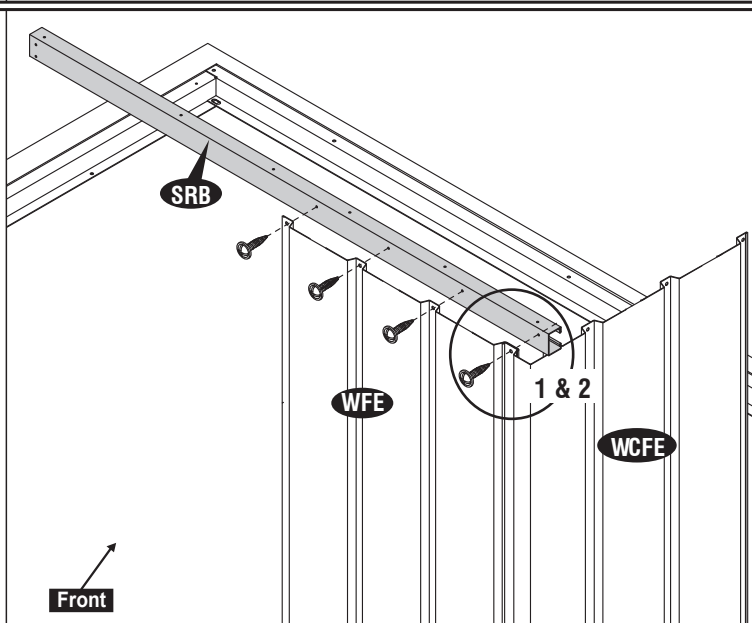
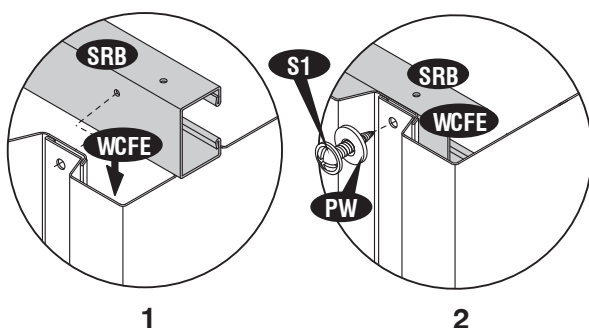

5

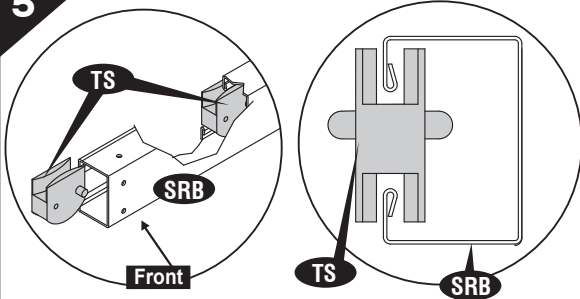

Note



Make sure the position of the projection on (TS) towards inside.

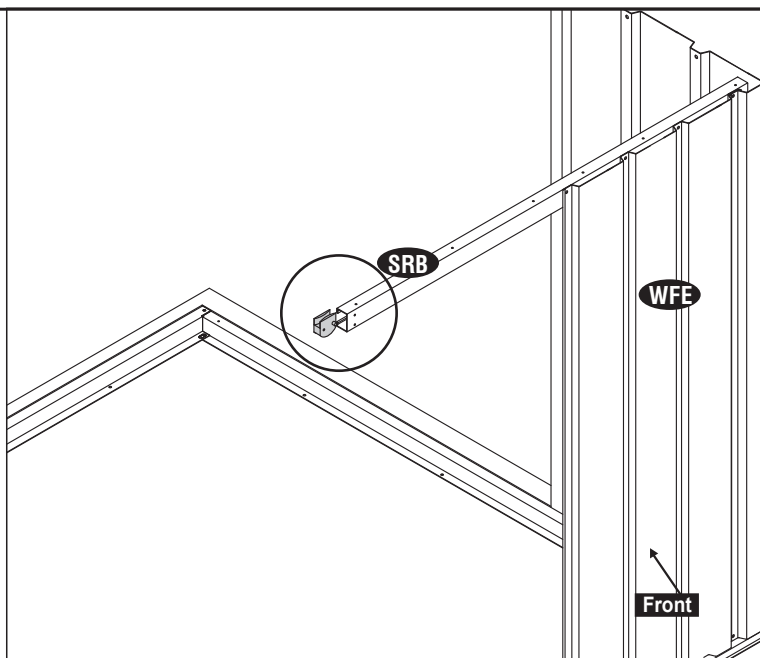

6

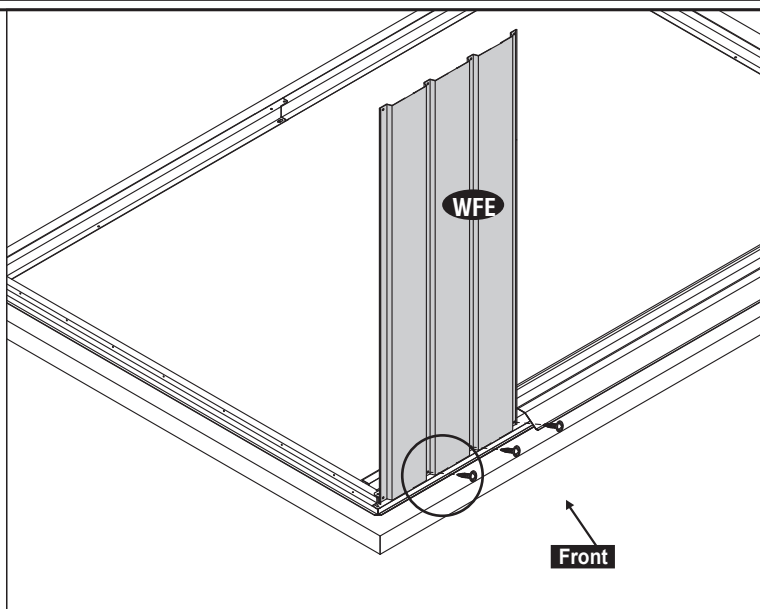
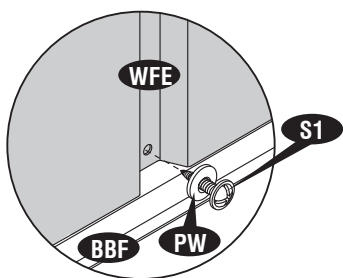

7

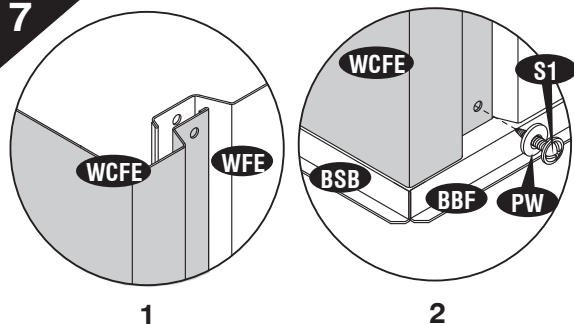

Note



Make sure the overlapping position is as shown in fig.1.

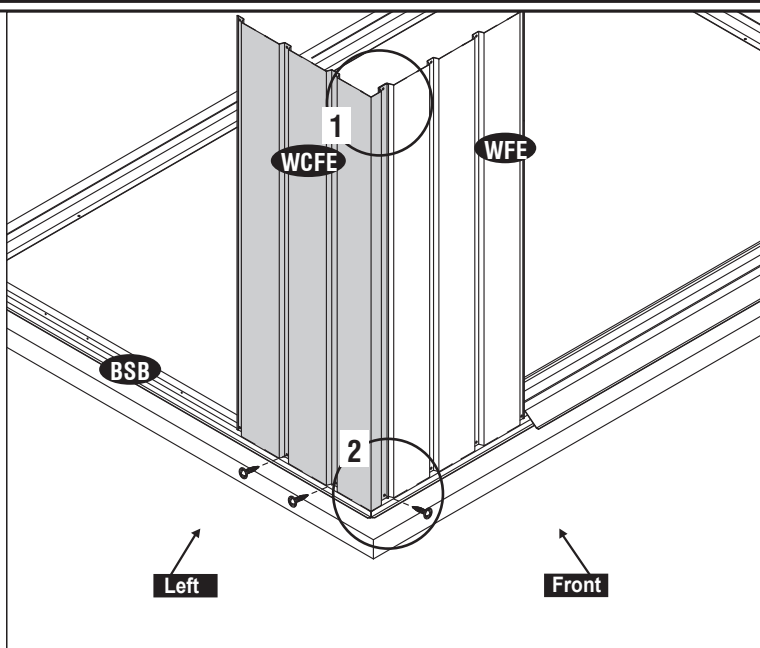

8

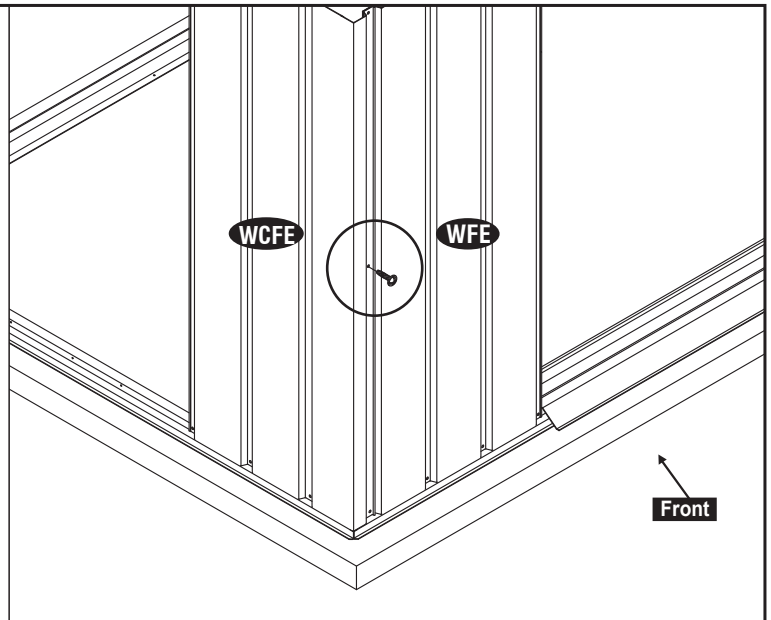
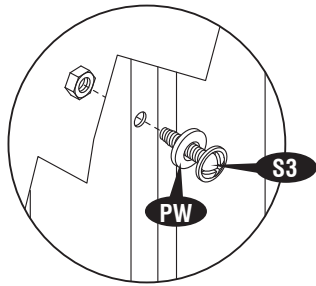

9

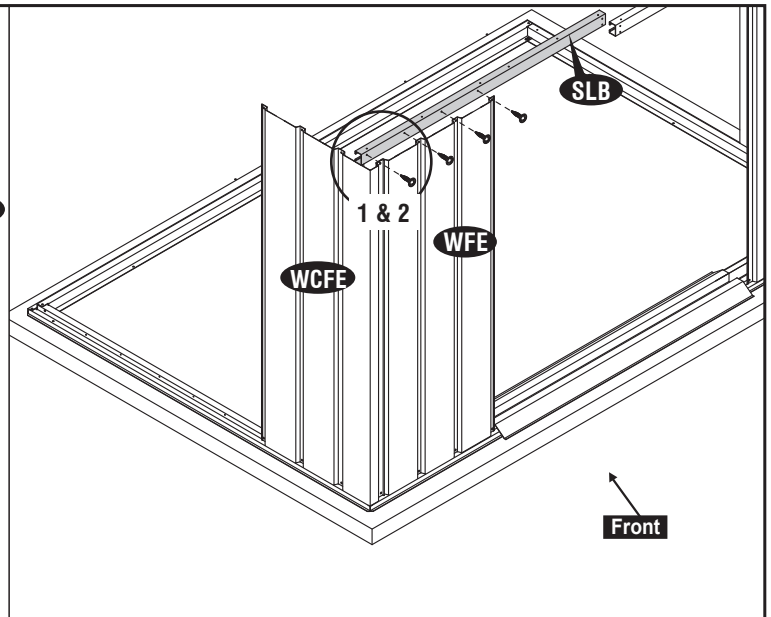
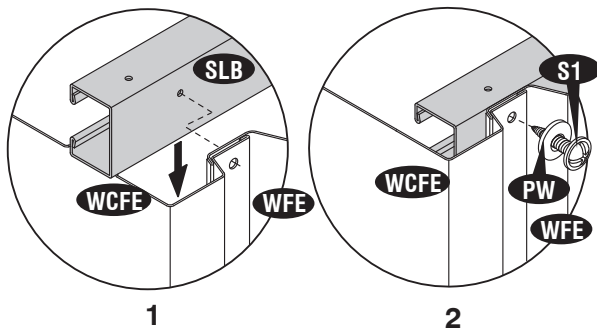

10

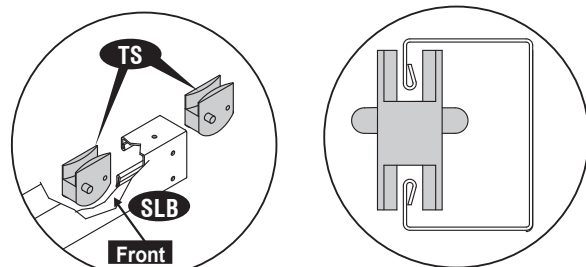
**Note**

Make sure the position of the projection on (TS) towards inside.

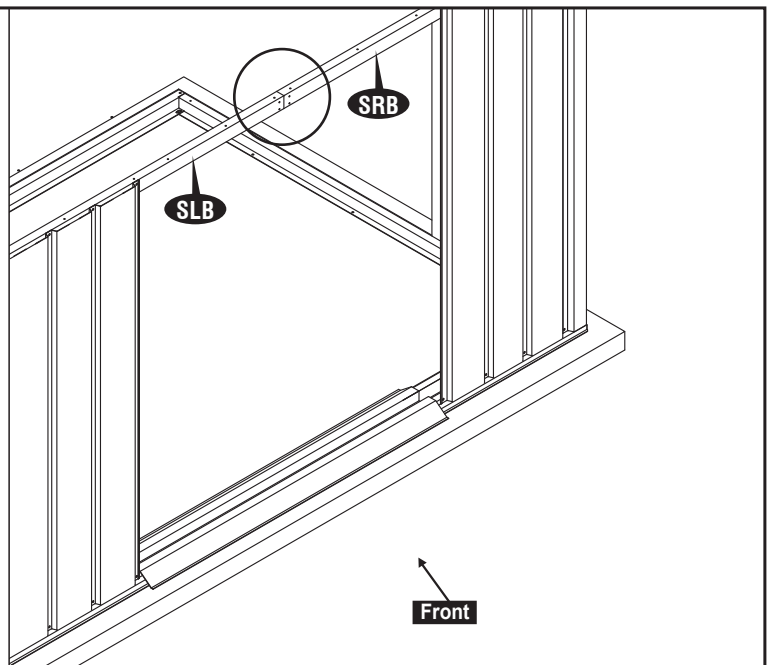

11

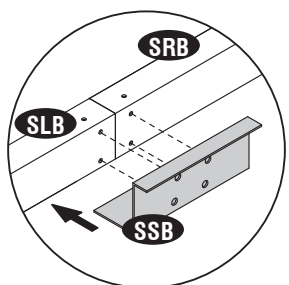

1

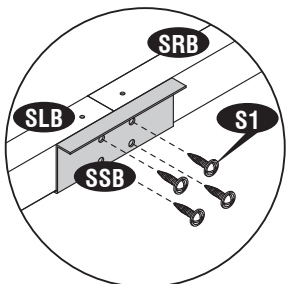

2

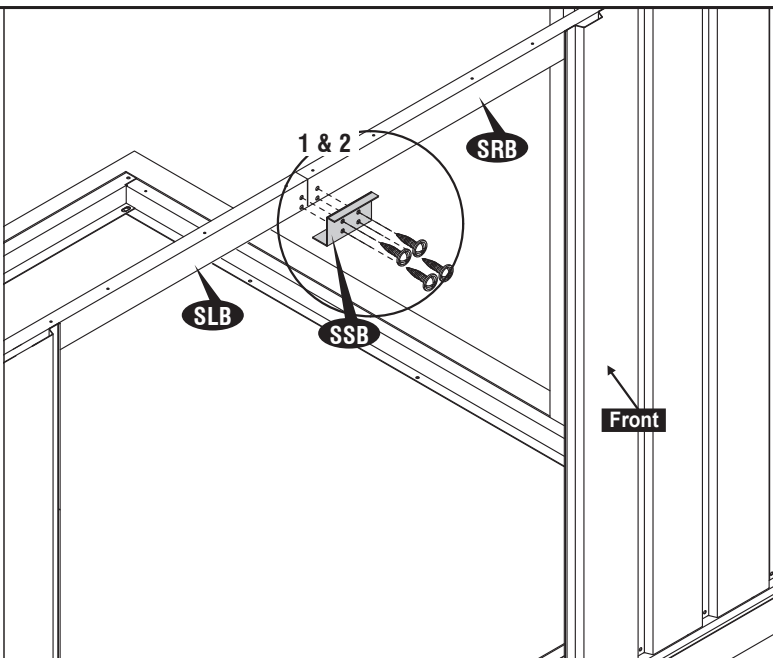

12

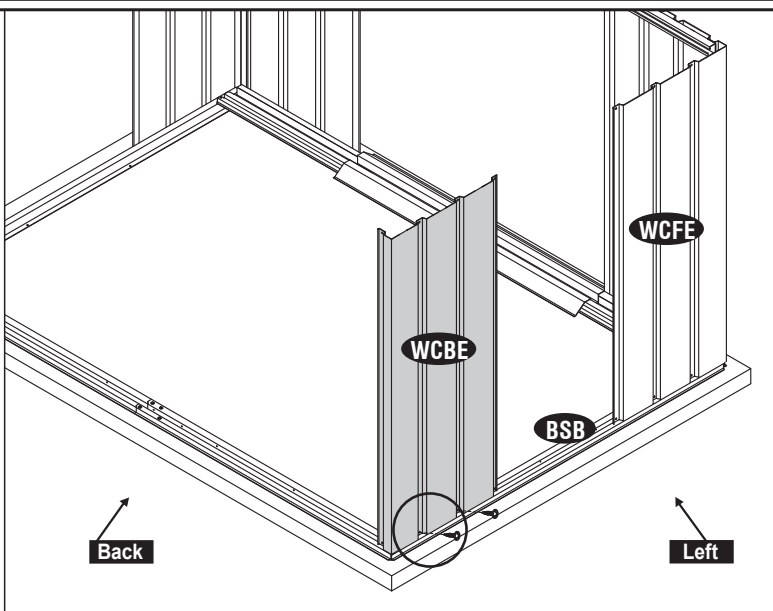
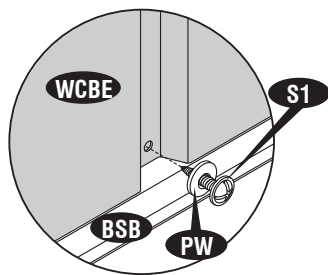

13

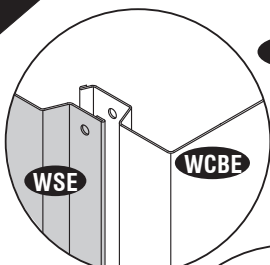

1

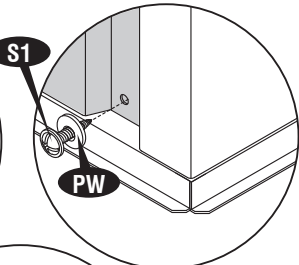

2

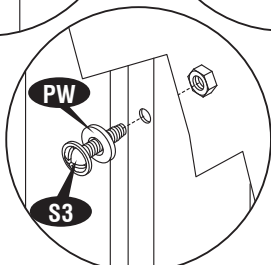

3

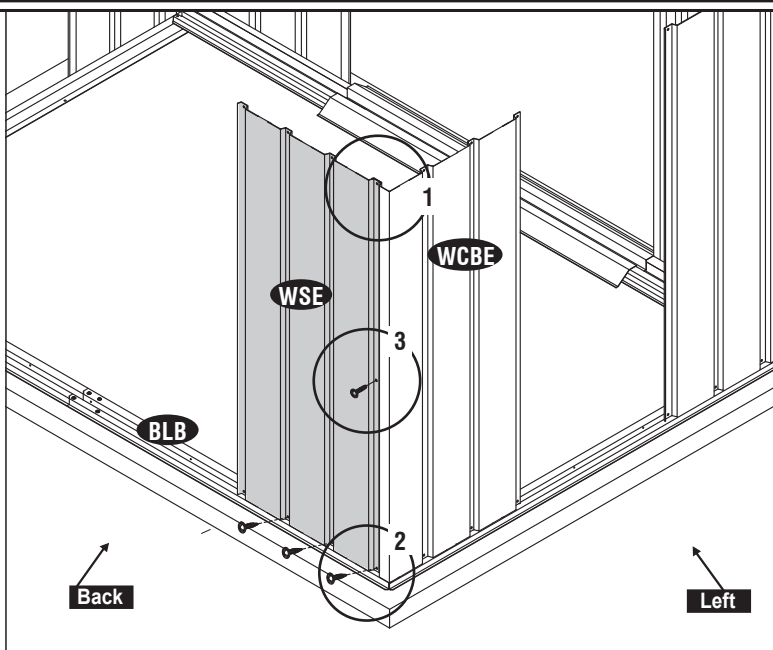

14

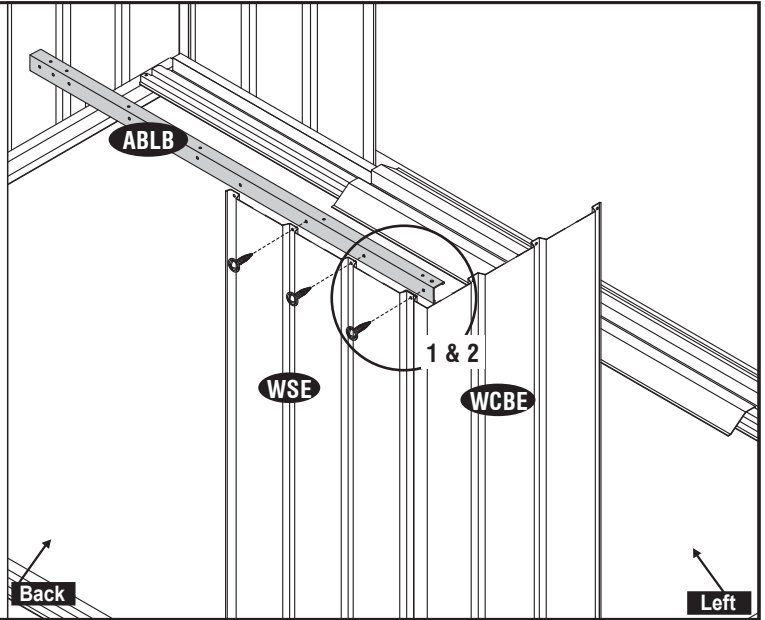
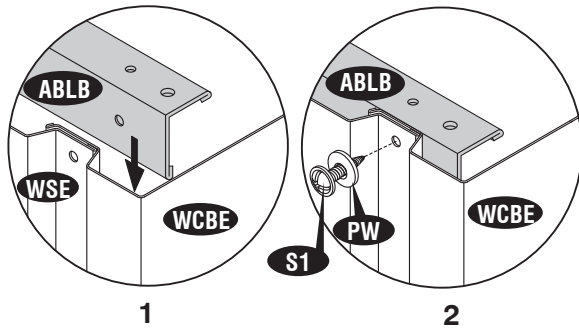

15

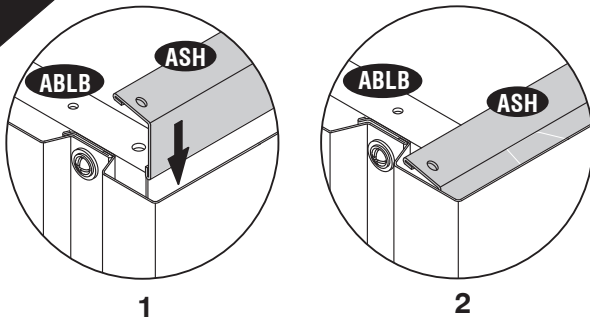

Note Top angle (ASH) must sit on top angle (ABL).

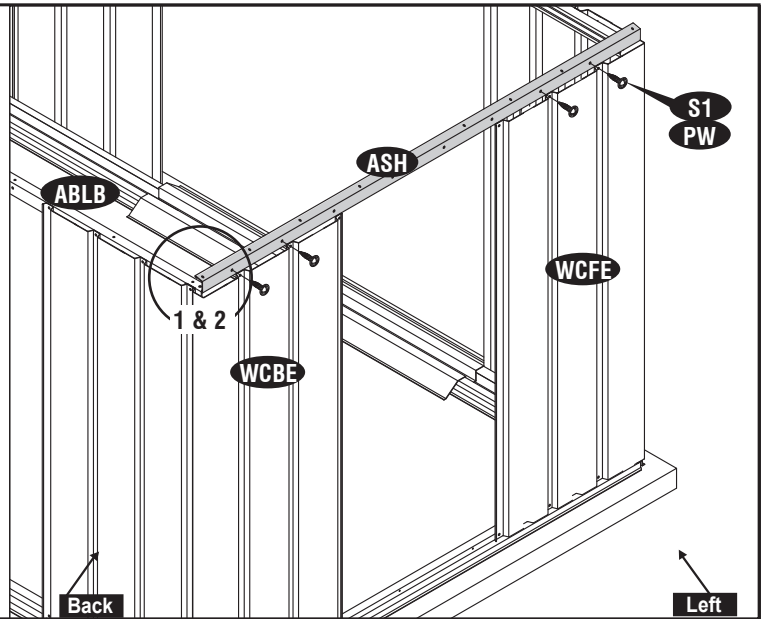

16

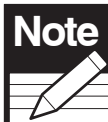
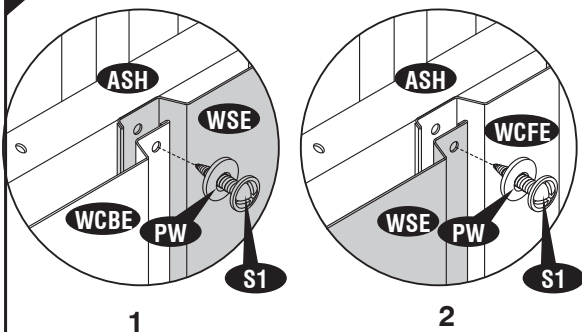

Note Make sure the overlapping position is as shown in fig.1 & 2.

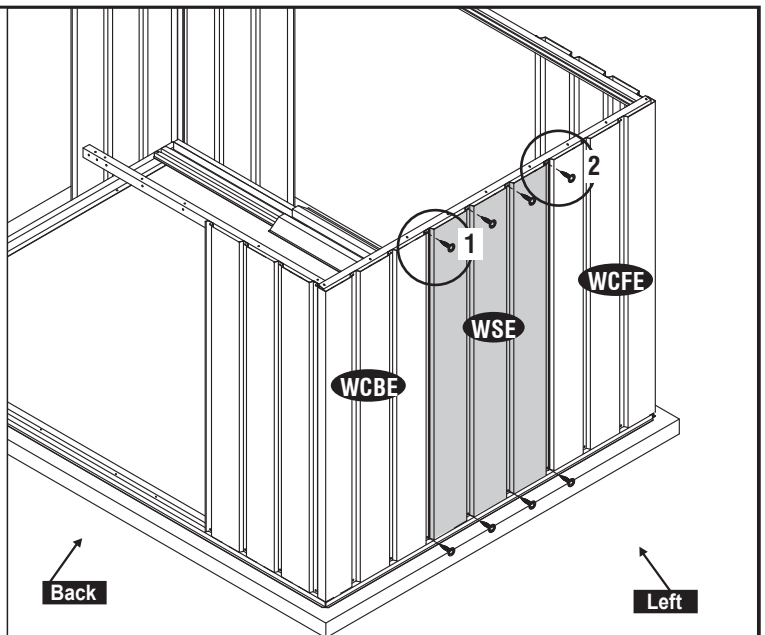

17

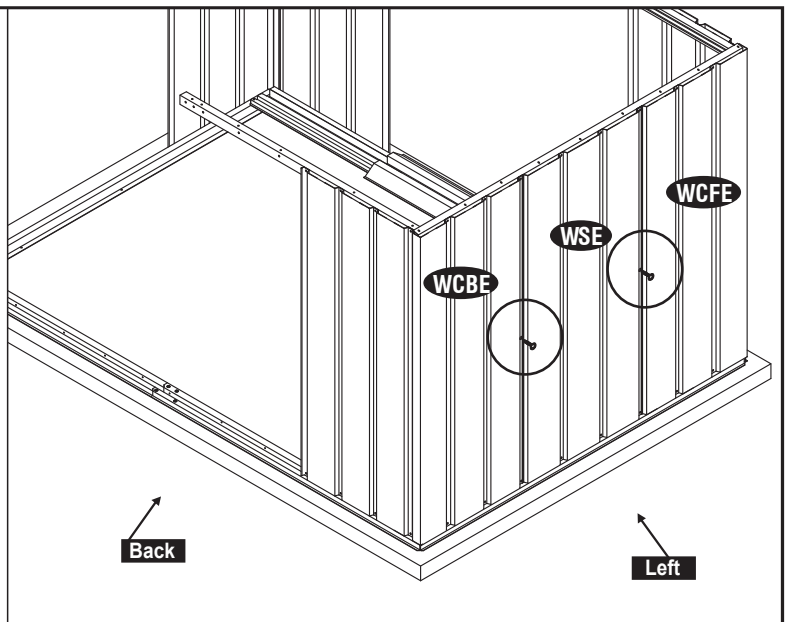
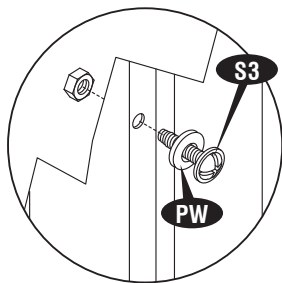

18

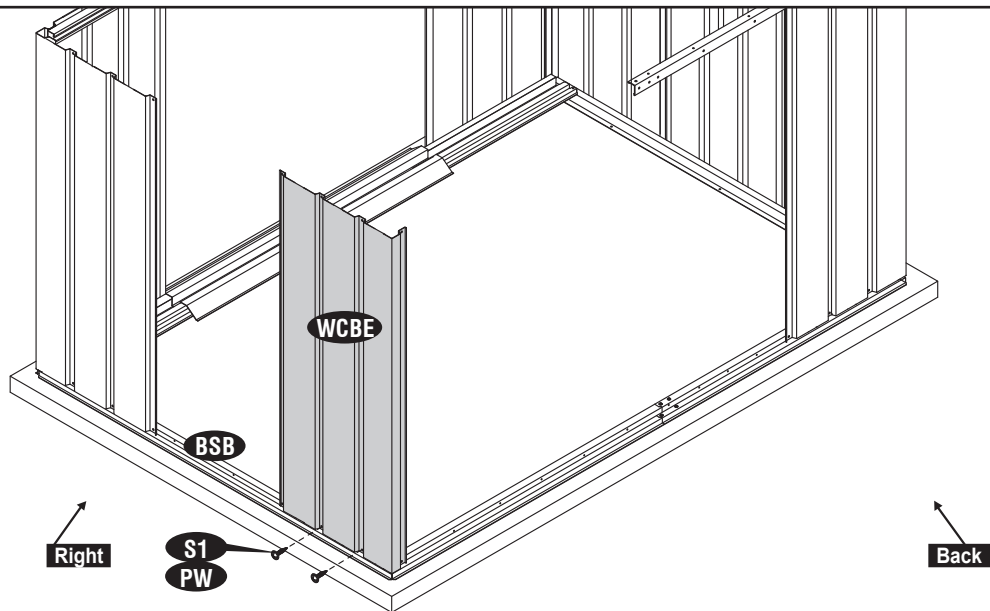

19

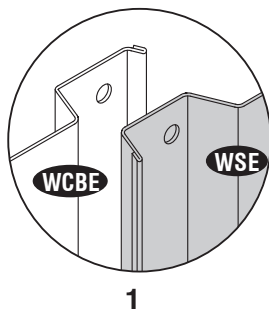

1

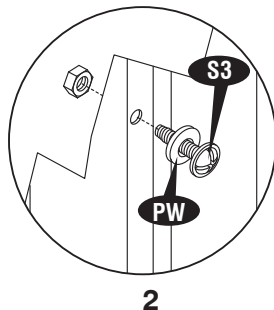

2



Note Make sure the overlapping position is as shown in fig.1.

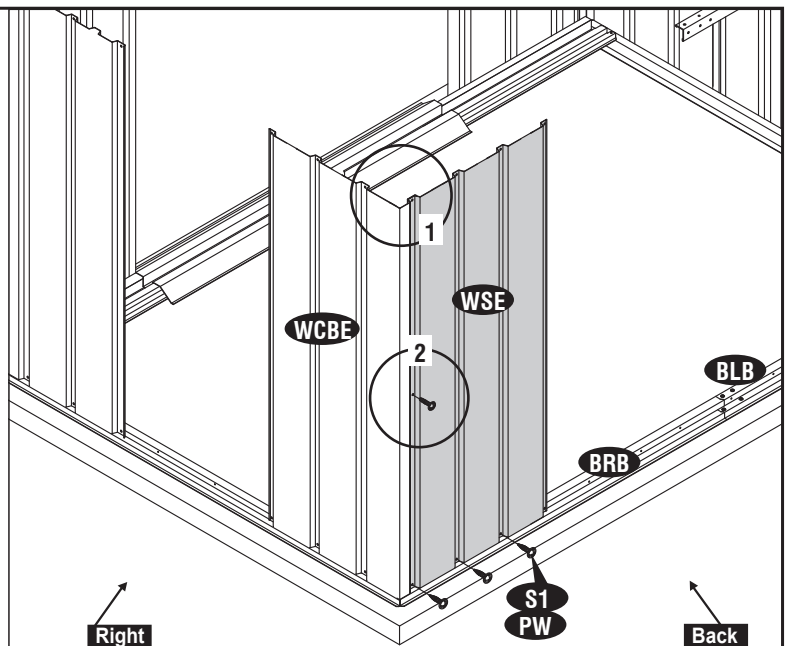

20

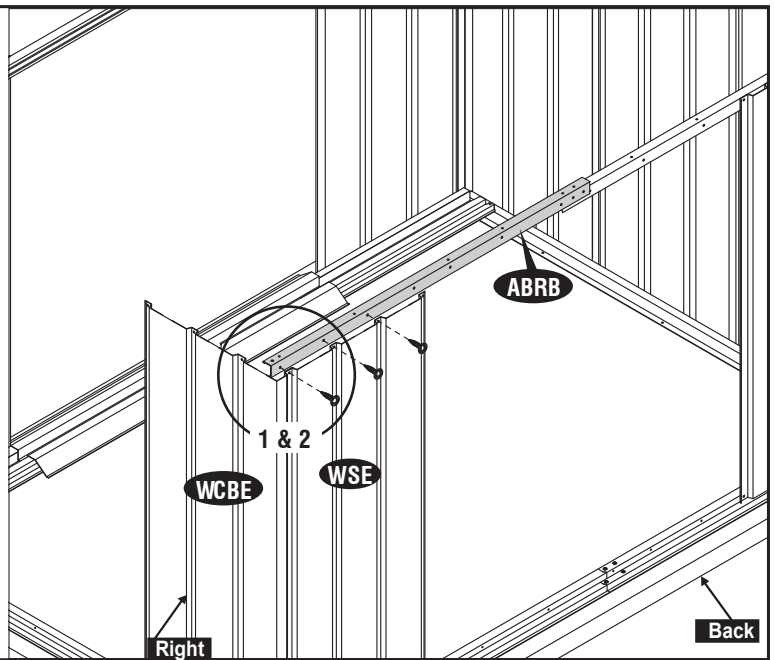
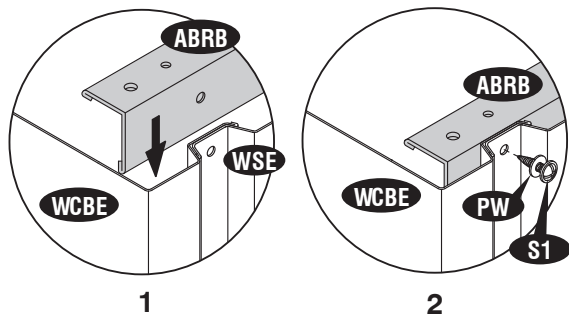

21

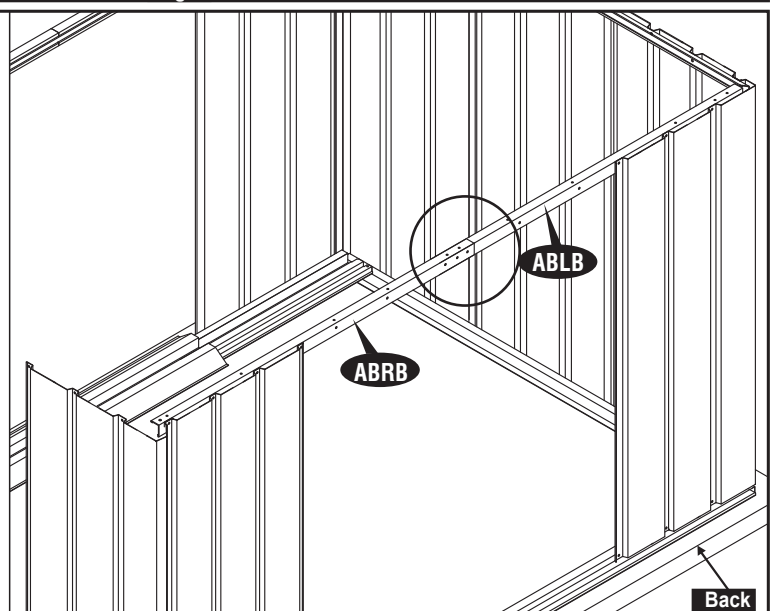
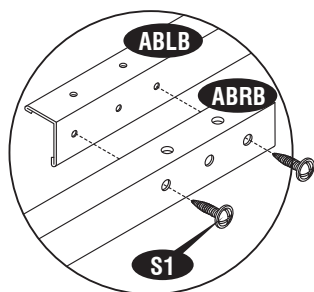

22

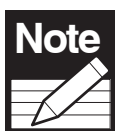
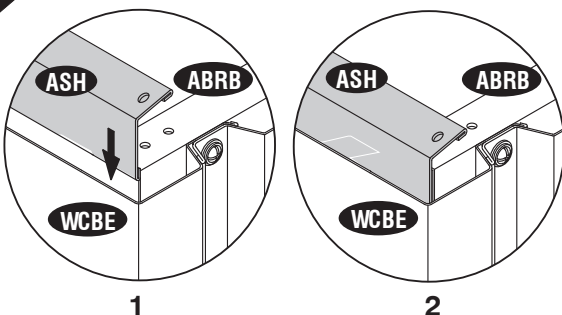

Note Top angle (ASH) must sit on top angle (ABRB).

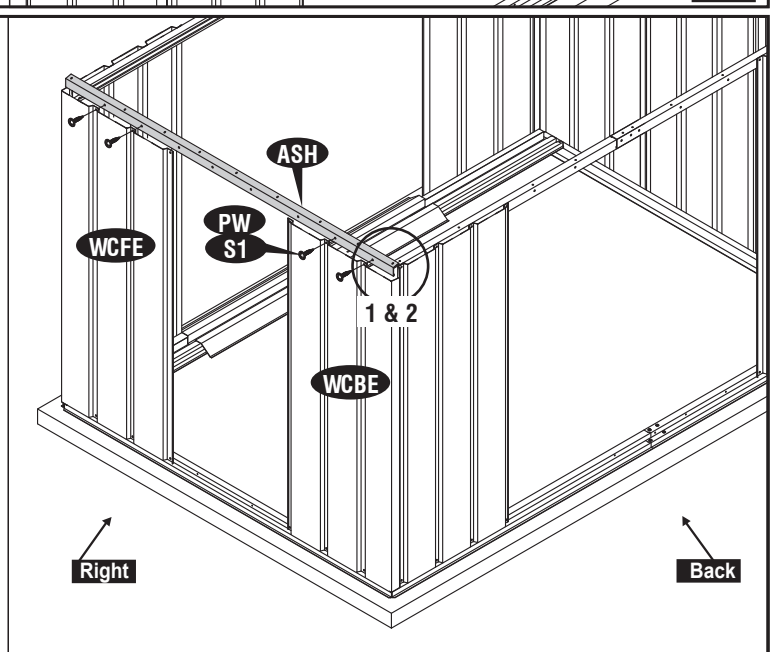

23

1

ASH

WCFE

PW

WSE

S1

2

ASH

PW

WSE

WCBE

S1

3

S3

Note

Make sure the overlapping position is as shown in fig.1 & 2.

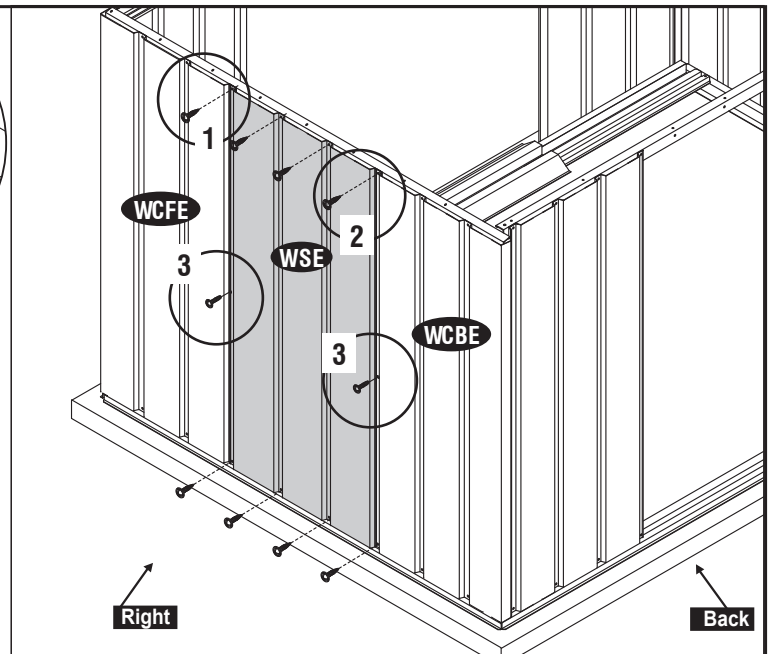

24

1

2

Note

Make sure the overlapping position is as shown in fig.1.

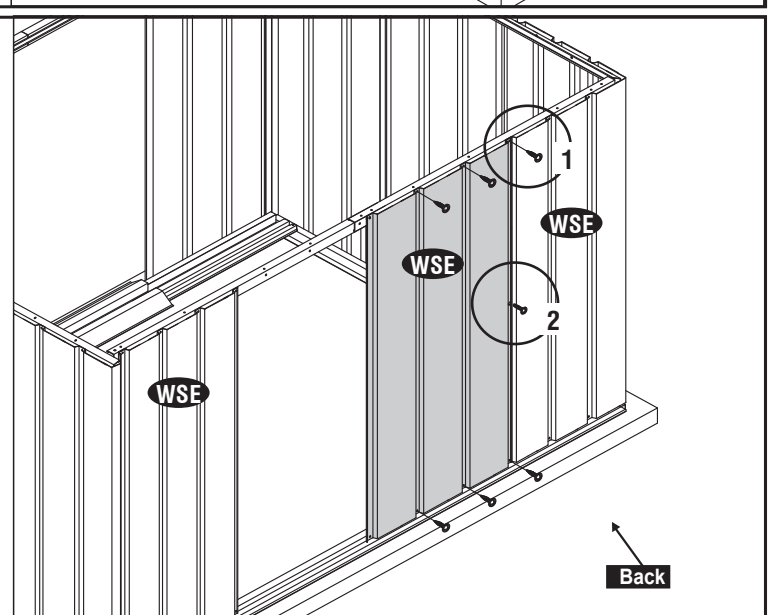

25

1

2

Note Make sure the overlapping position is as shown in fig.1.

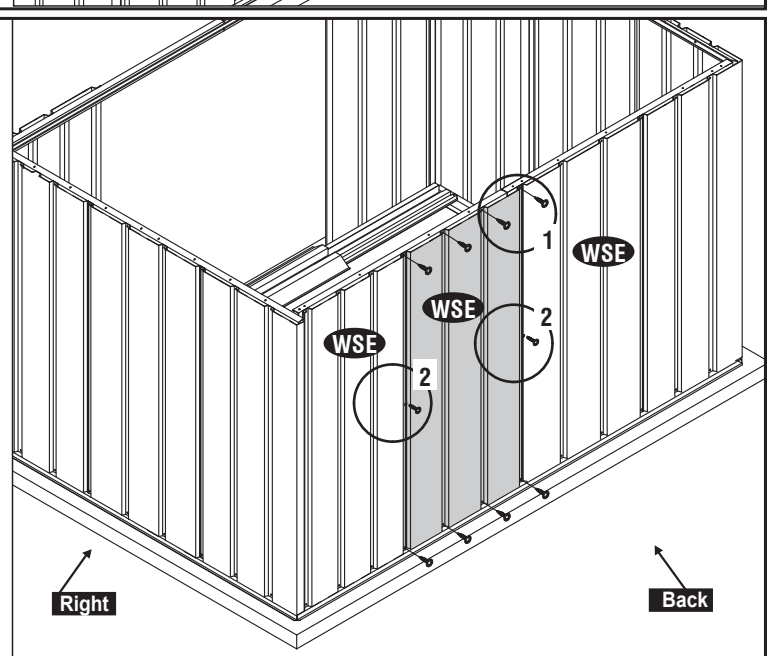

26

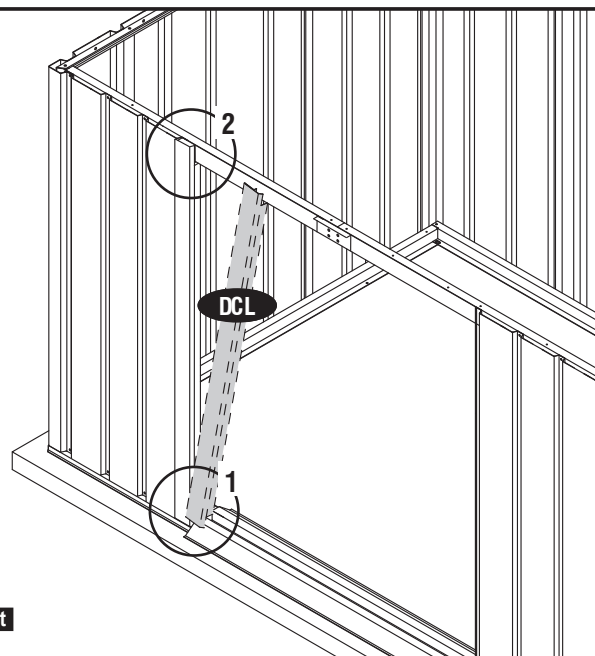
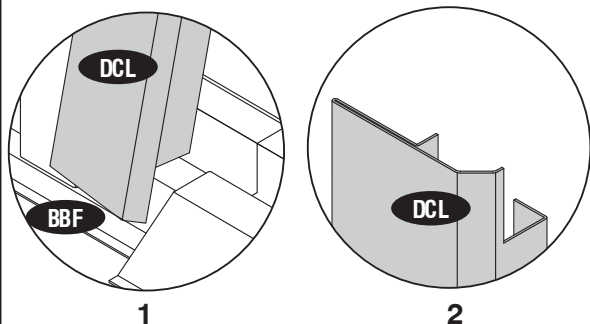

27

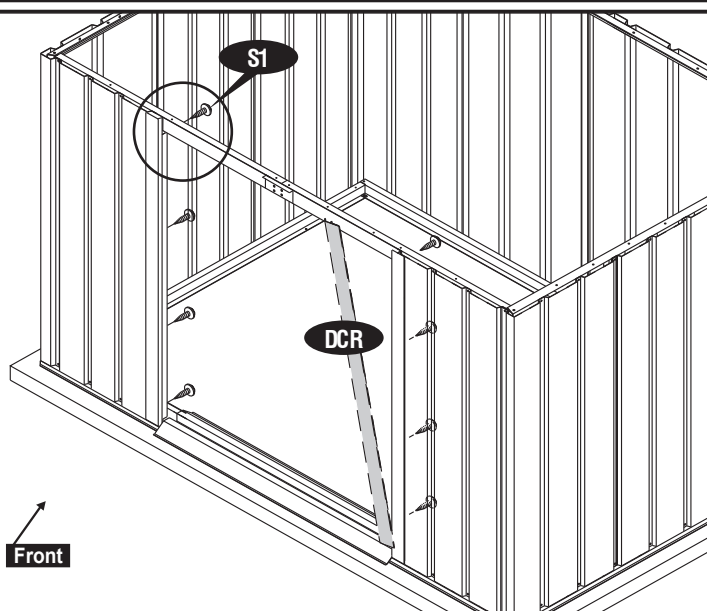
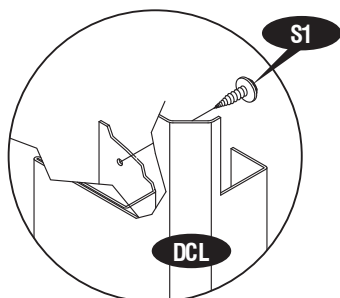

28

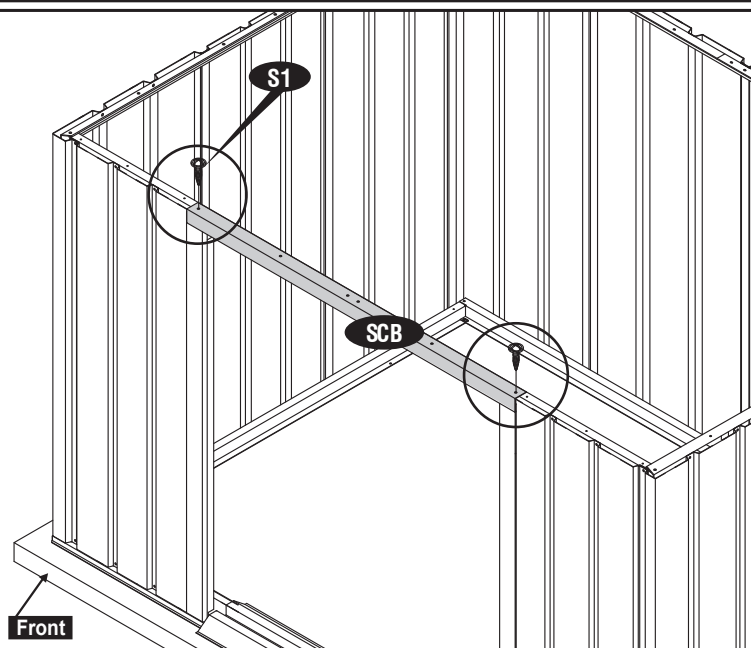
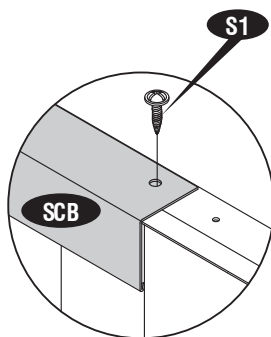

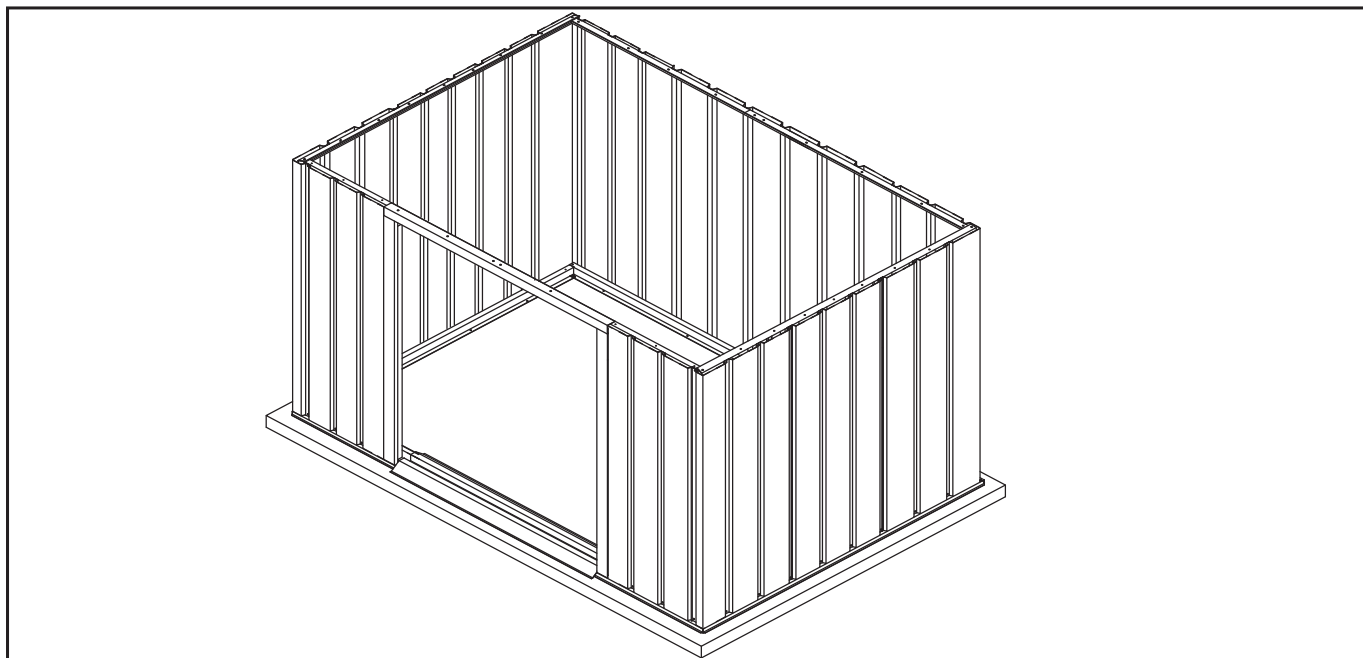

D. Roof

Note

All parts are clearly marked and care should be taken to use the correct one. Remove the polyethylene film before start assembling.

Parts needed

CODE	QTY
GPLG	2
GPRG	2
GPS	2
SB1G	2
SB2G	2
RSH	3
RS1H	1
RPE1G	2
RPE2G	2
RPE3G	2
RF1G	2
RF2G	2
SBE1G	4
SBE2G	4
SBE3G	8

CODE	QTY
RF3B	2
RF4B	2
RFCH	2
GPVG	2
FC	2
WST	2.8mtrs
VC	4
TC	4
PW	113
S1	131
S2	4
S3	66

IMPORTANT

Use screws with plastic washers on top of prepainted surface only.

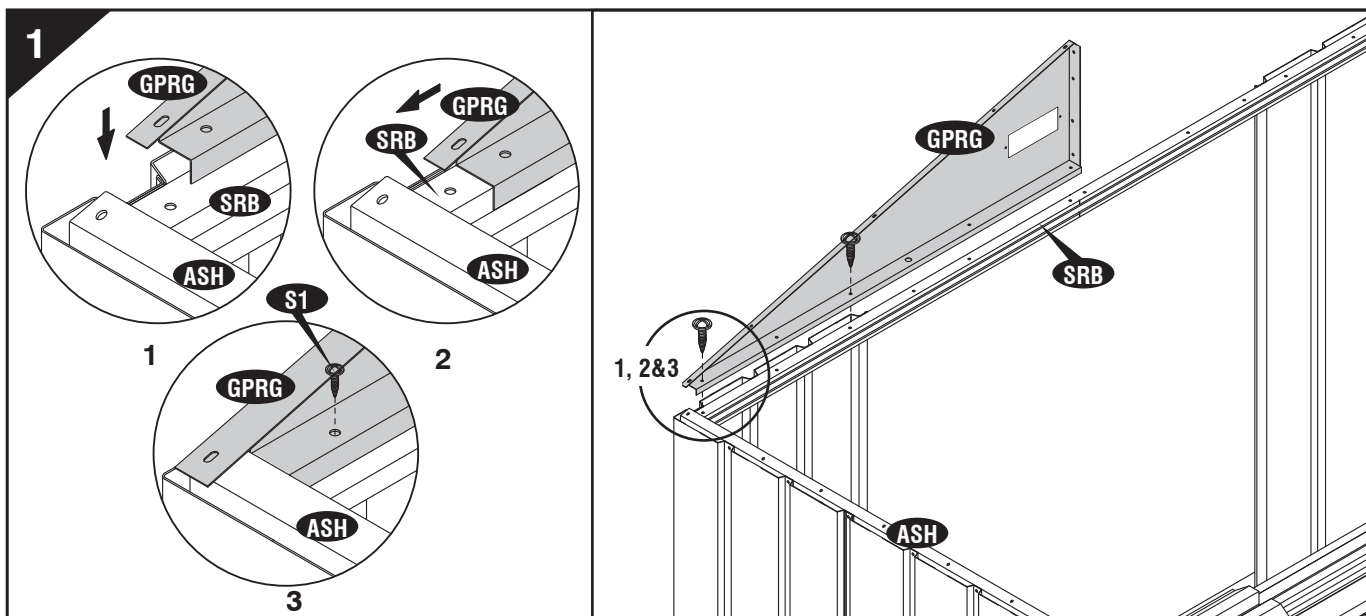
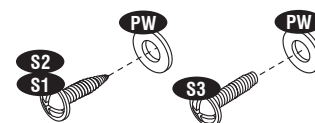

2

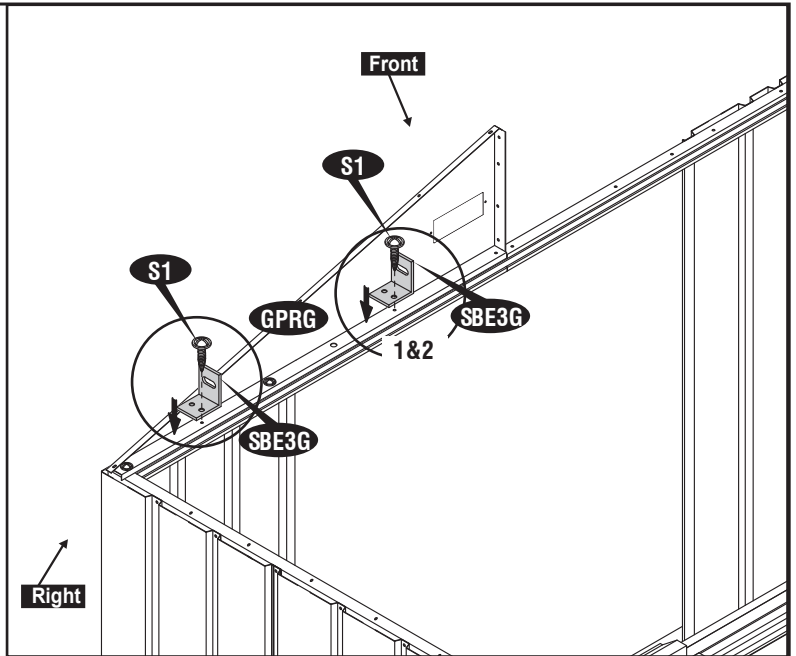
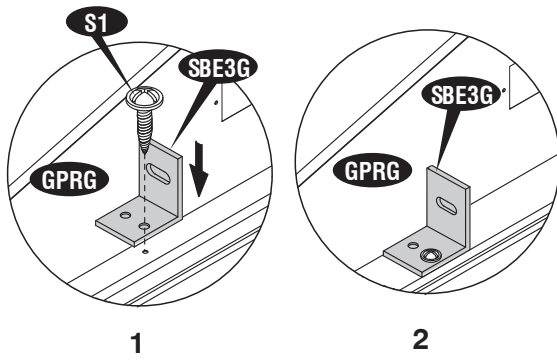

3

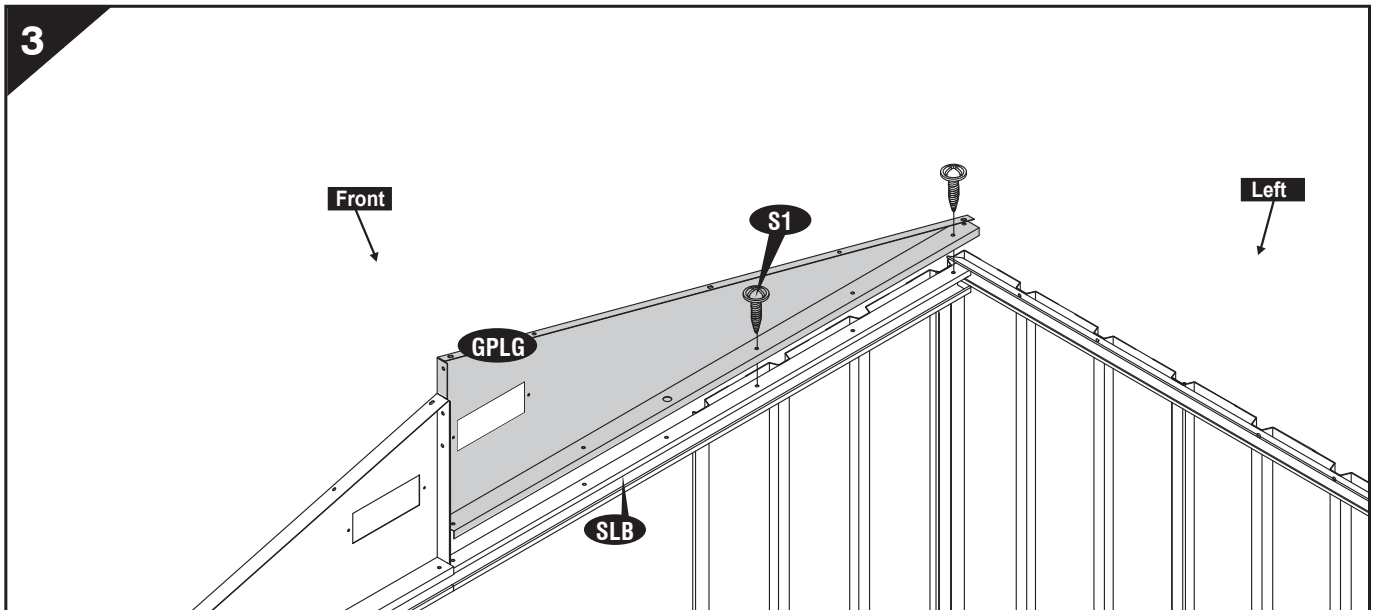

4

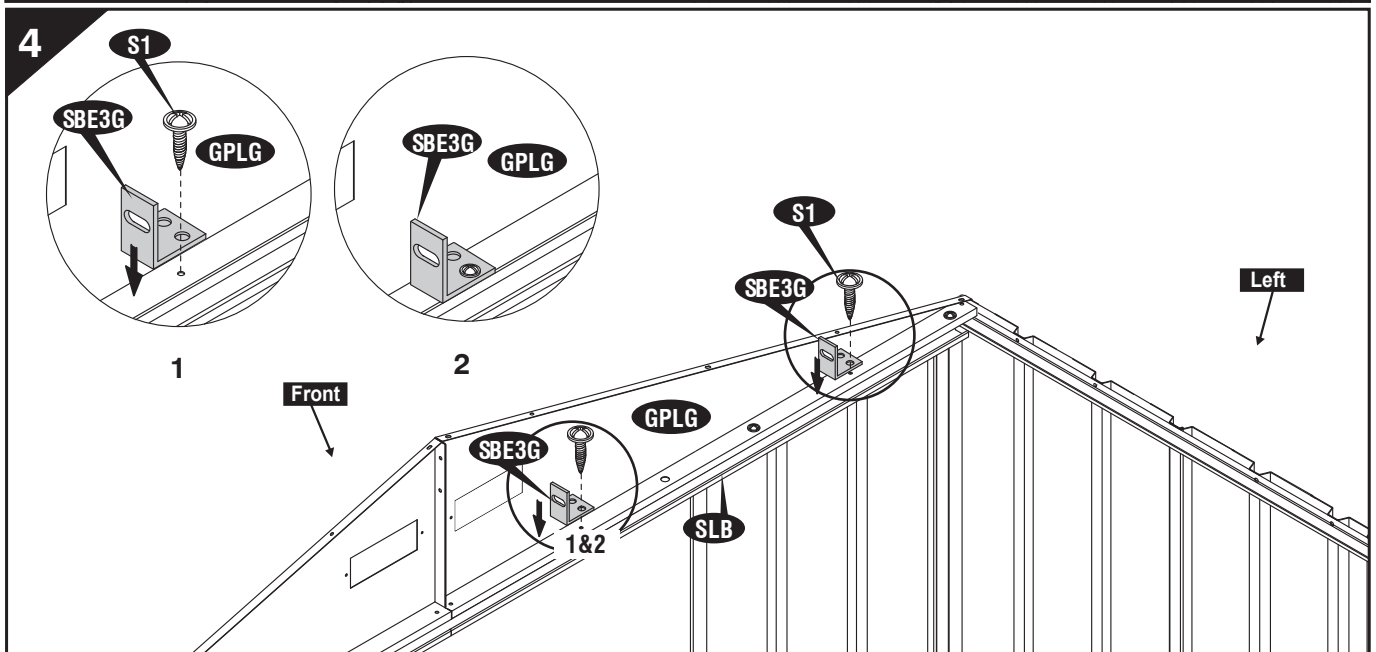

5

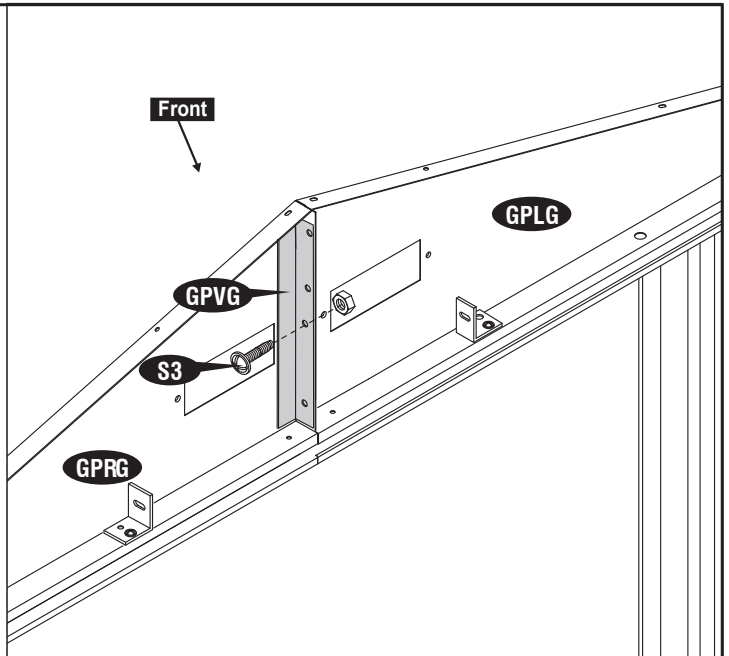

6

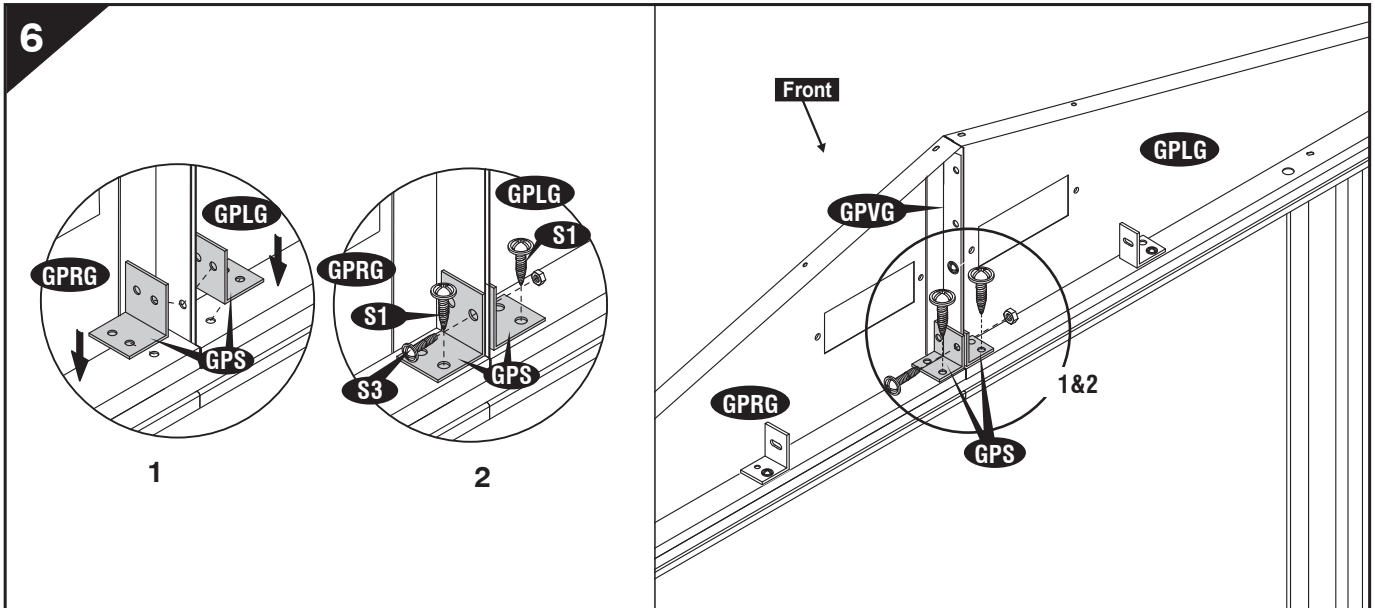

7

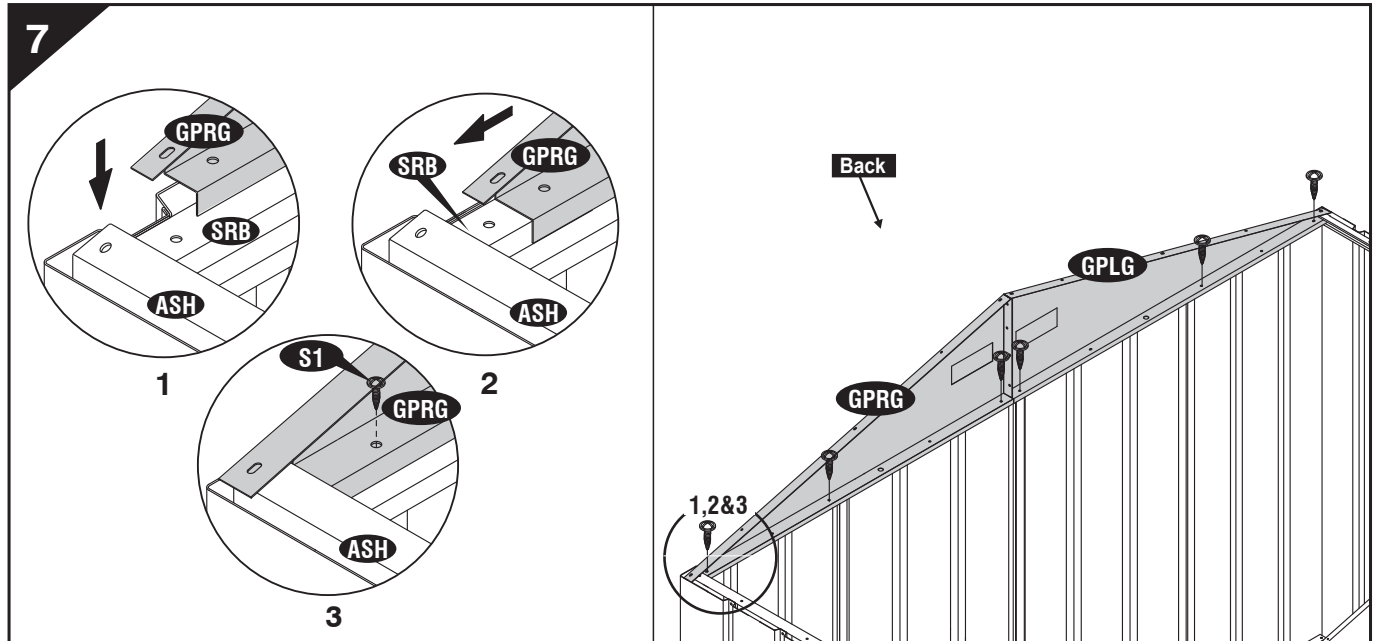

IMPORTANT: USE HAND GLOVES TO PREVENT INJURY

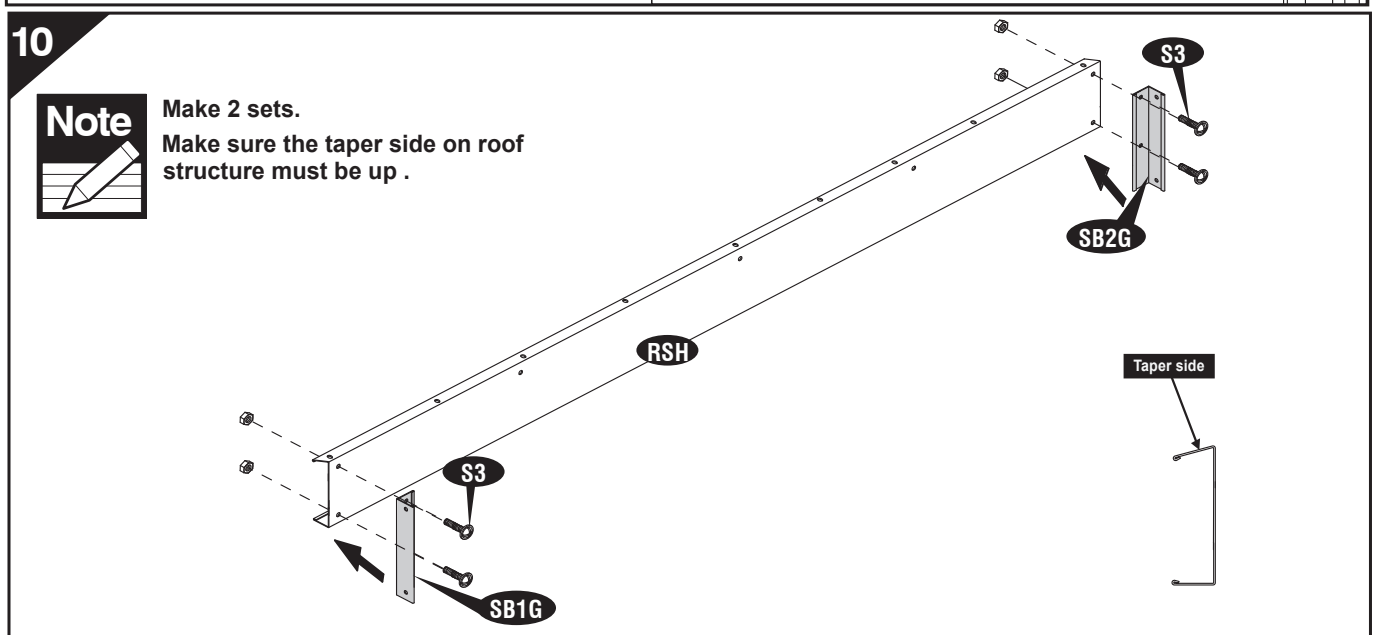
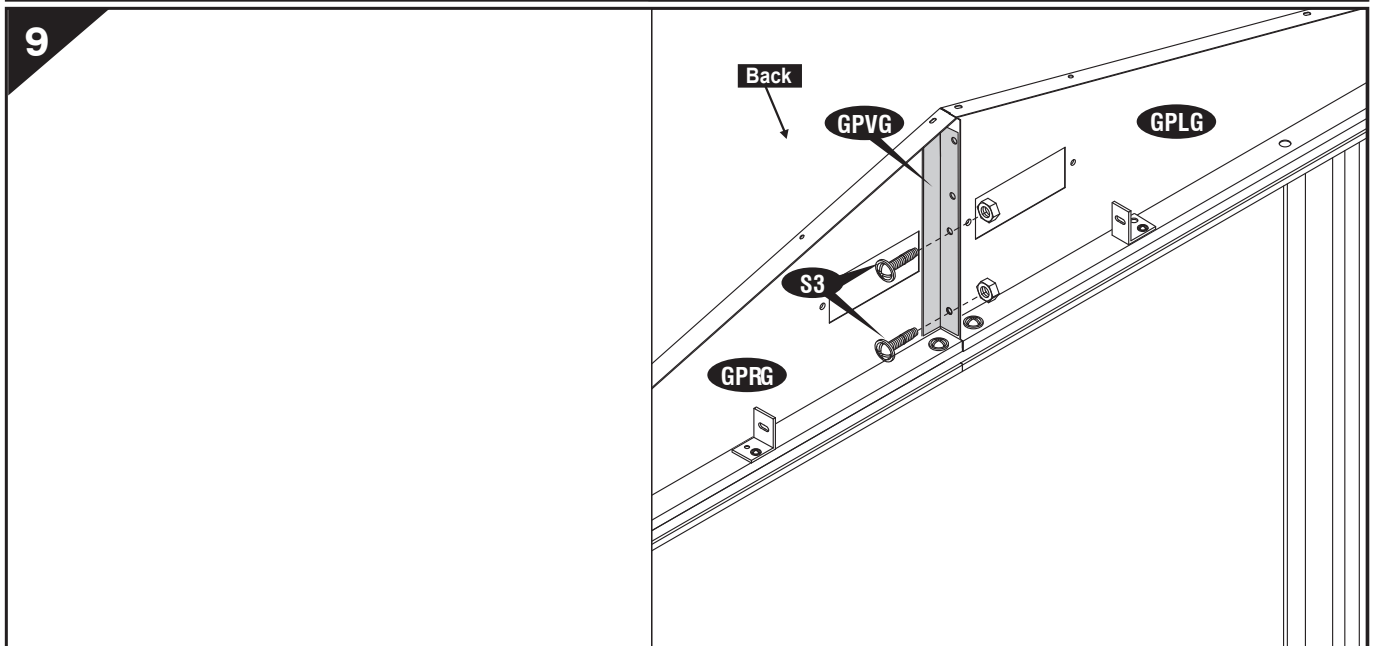
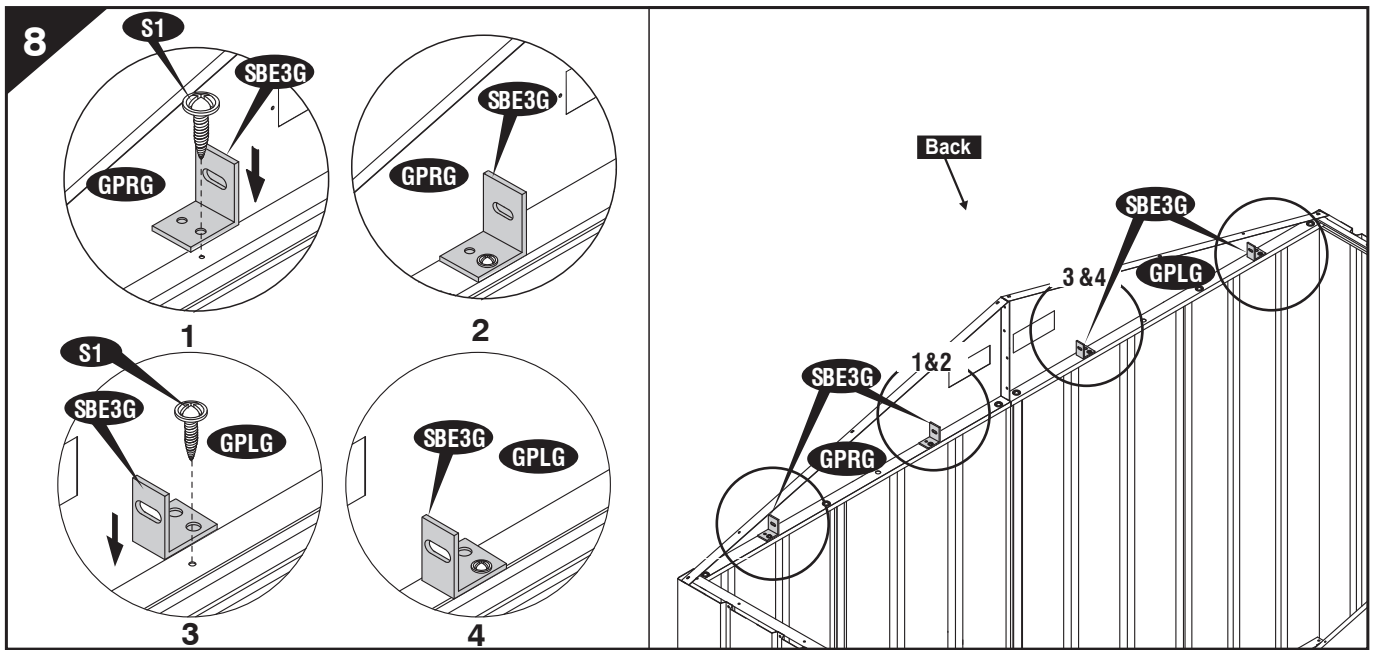

11

Note

Make 2 sets.
Make sure the taper side on roof structure must be up .

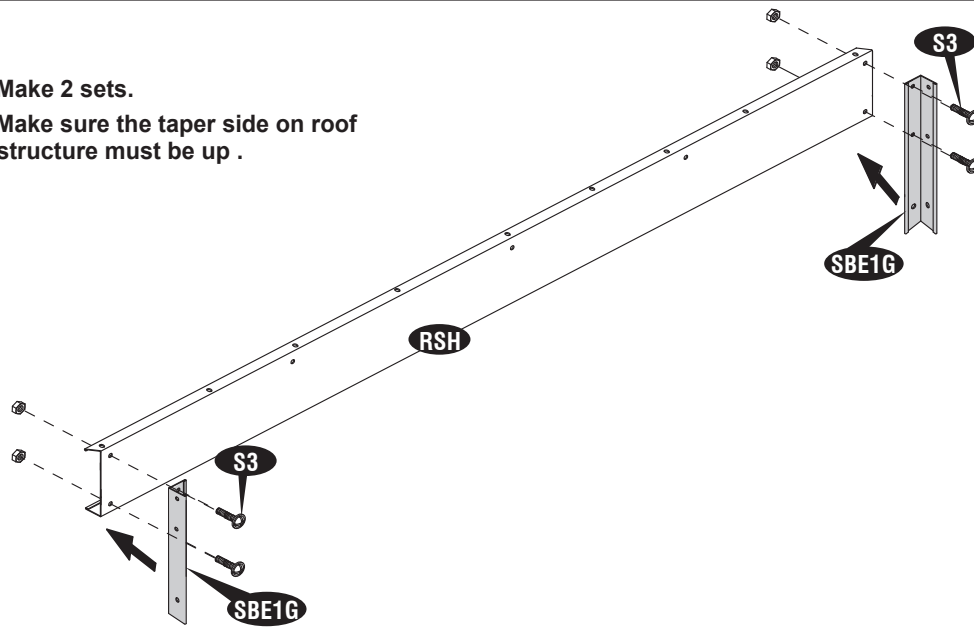

12

Note

Make 2 sets.
Make sure the taper side on roof structure must be up .

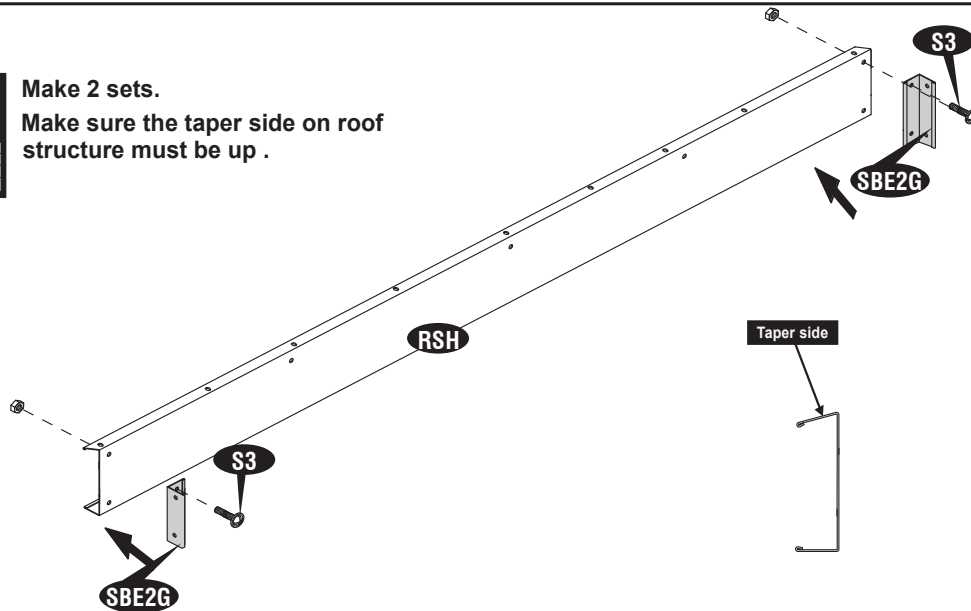

13

Note

Make sure the taper side on roof structure must be same .

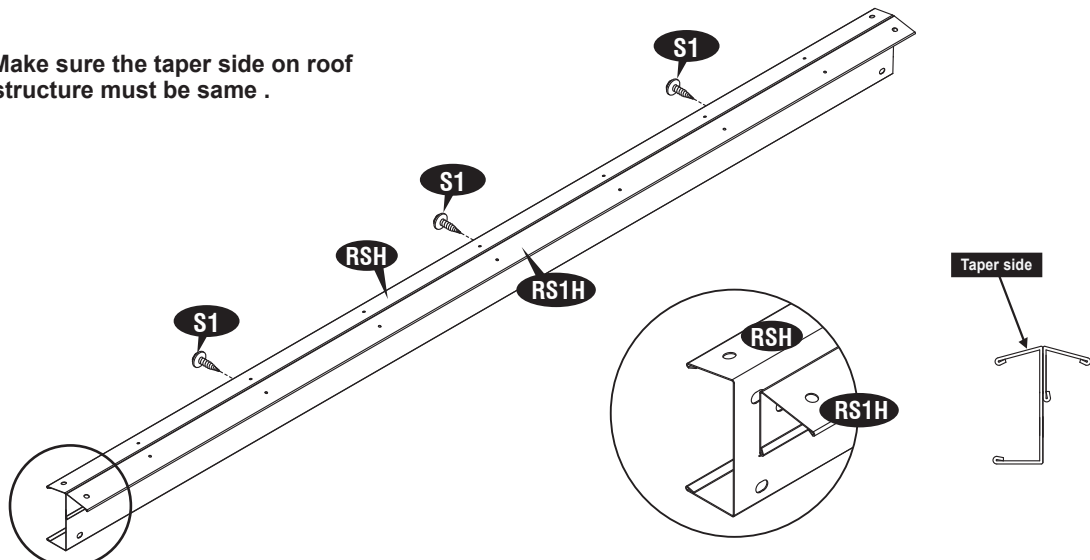

14

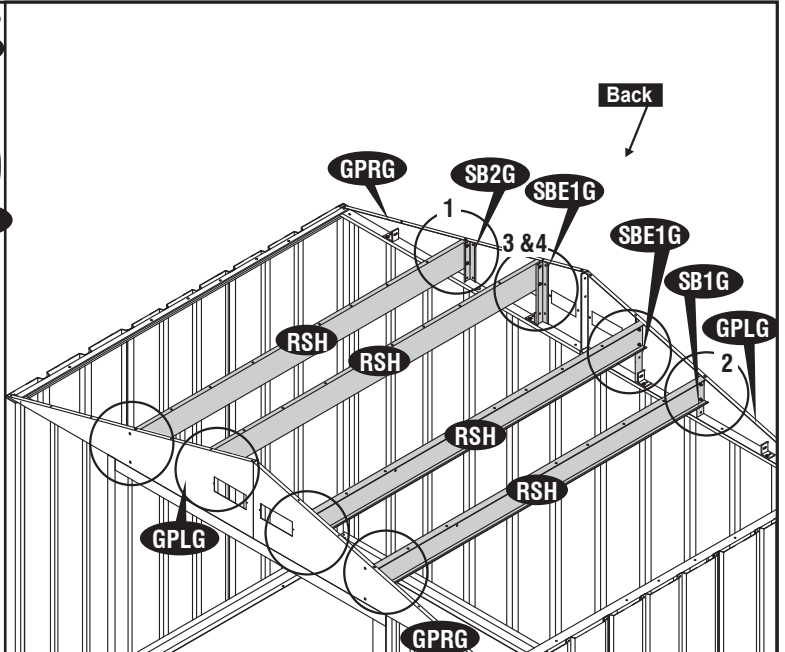
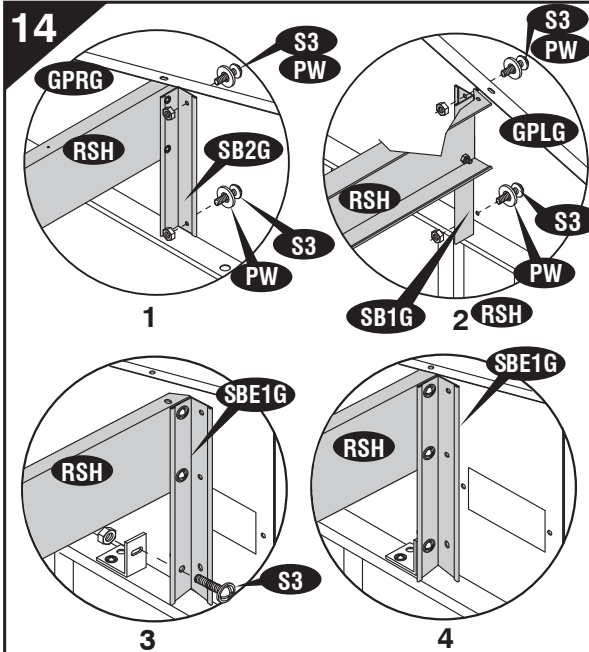

15

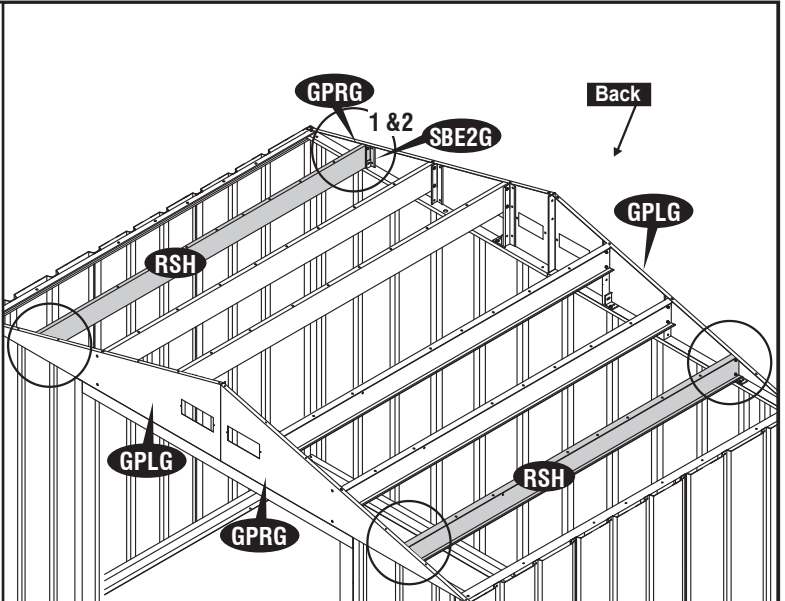
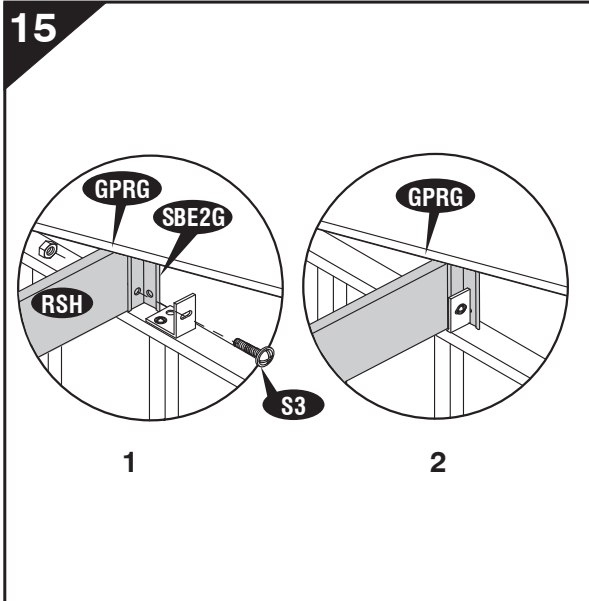

16

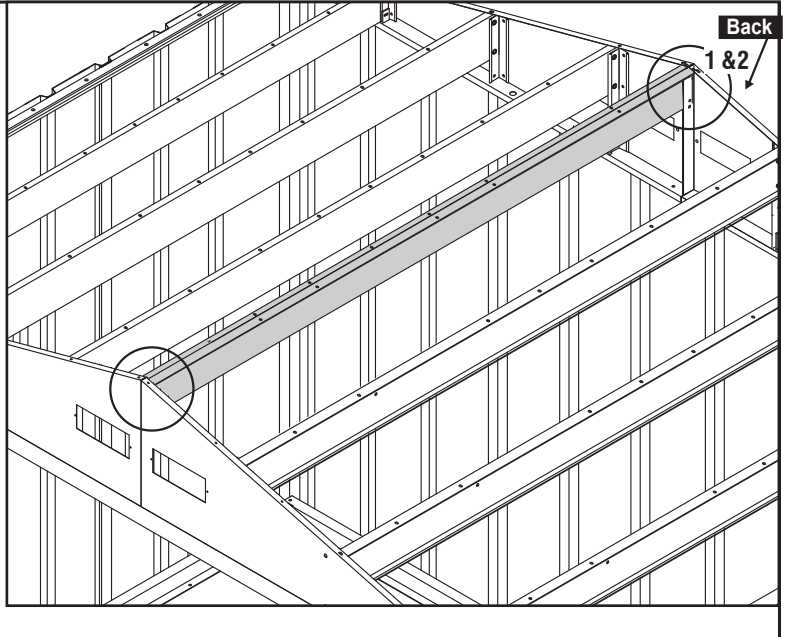
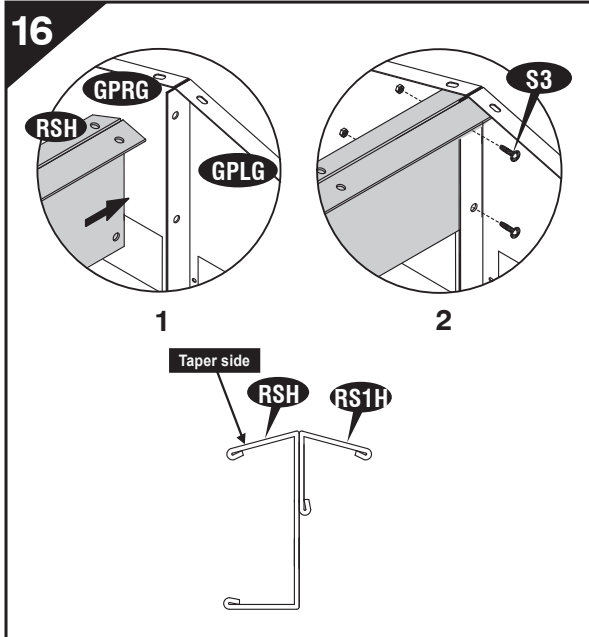

17

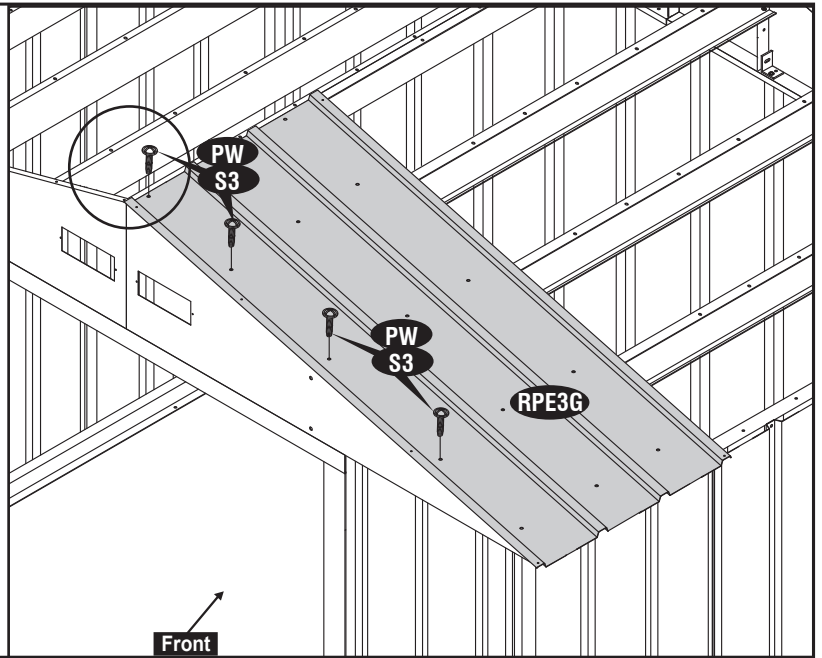
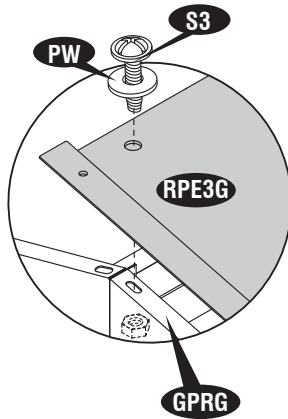

18

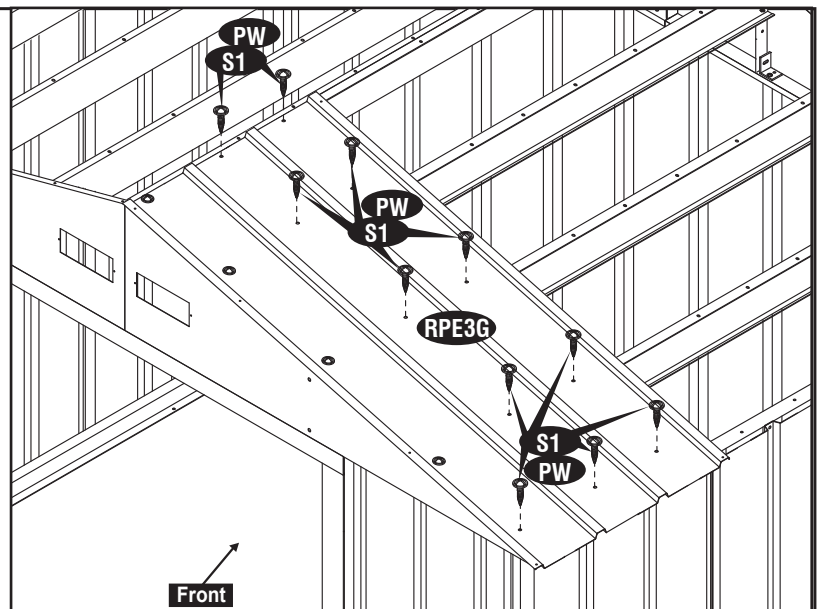

19

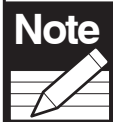
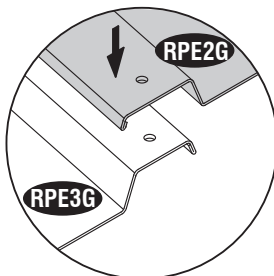

Note Make sure the overlapping position is as shown in fig.1.

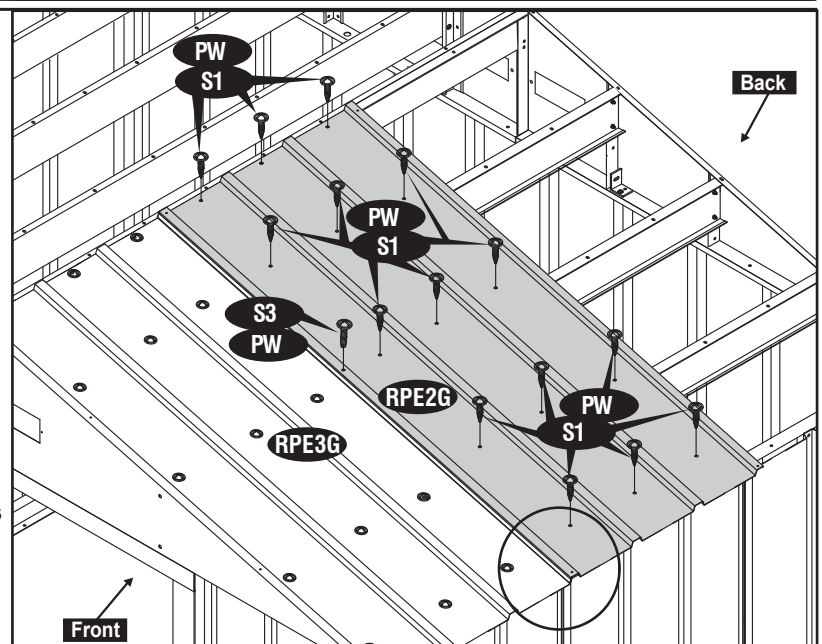

20

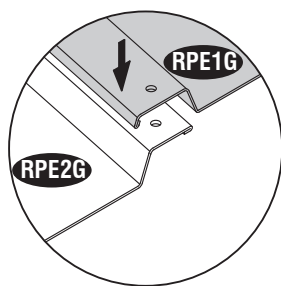
**Note**

Make sure the overlapping position is as shown in fig.1.

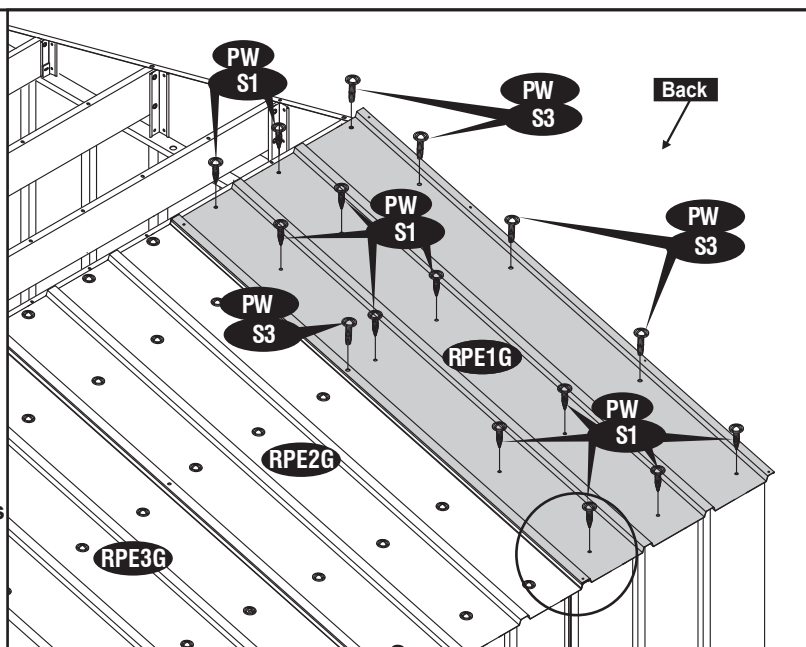

21

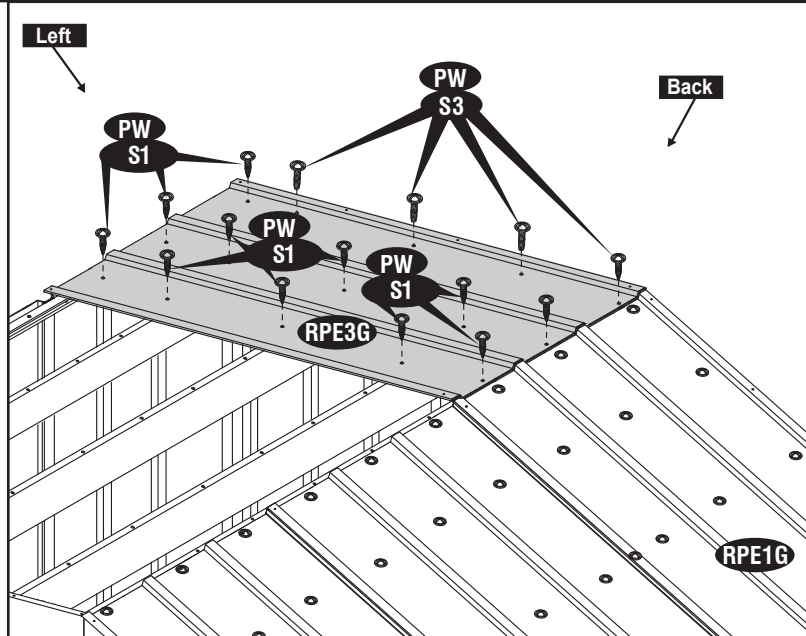

22

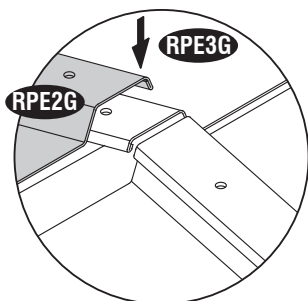
**Note**

Make sure the overlapping position is as shown in fig.1.

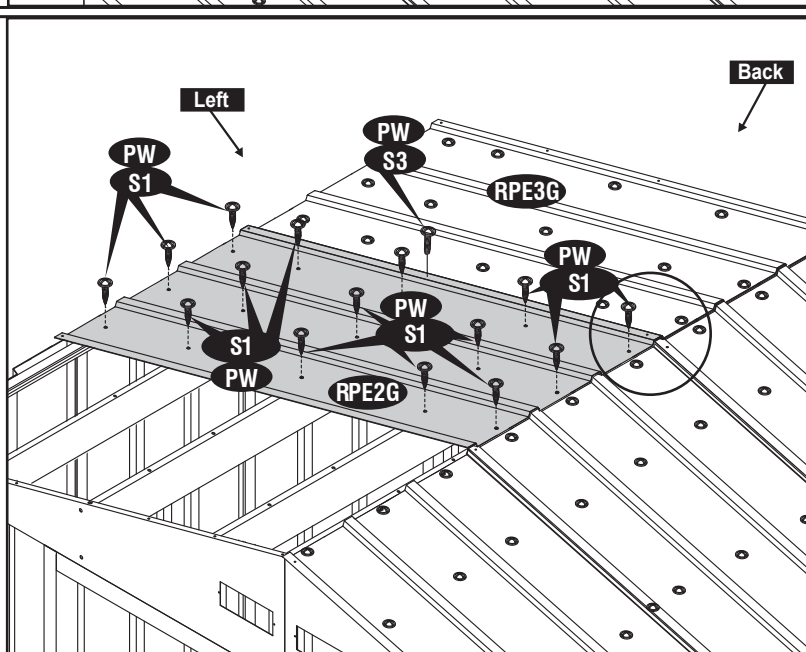

23

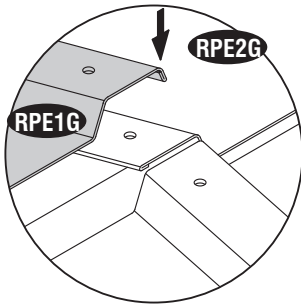
**Note**

Make sure the overlapping position is as shown in fig.1.

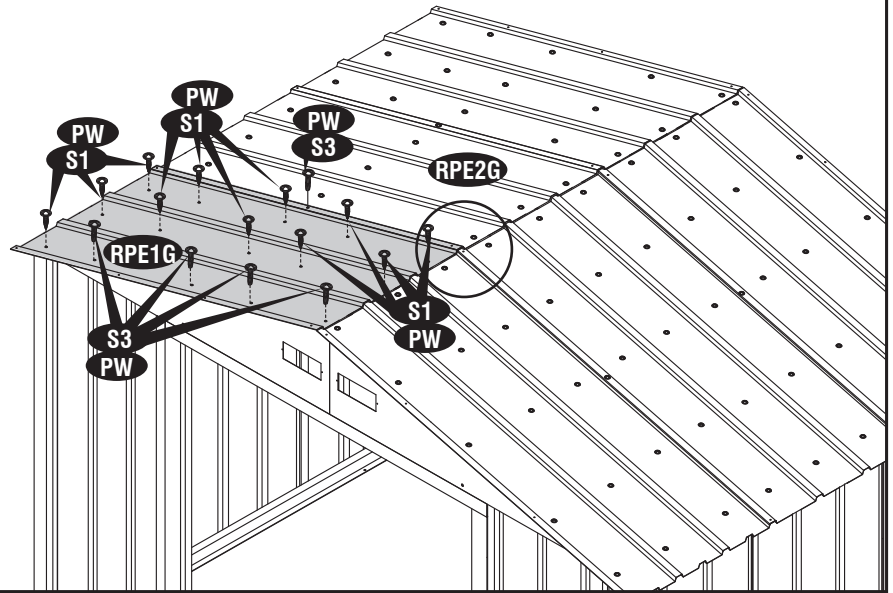

24

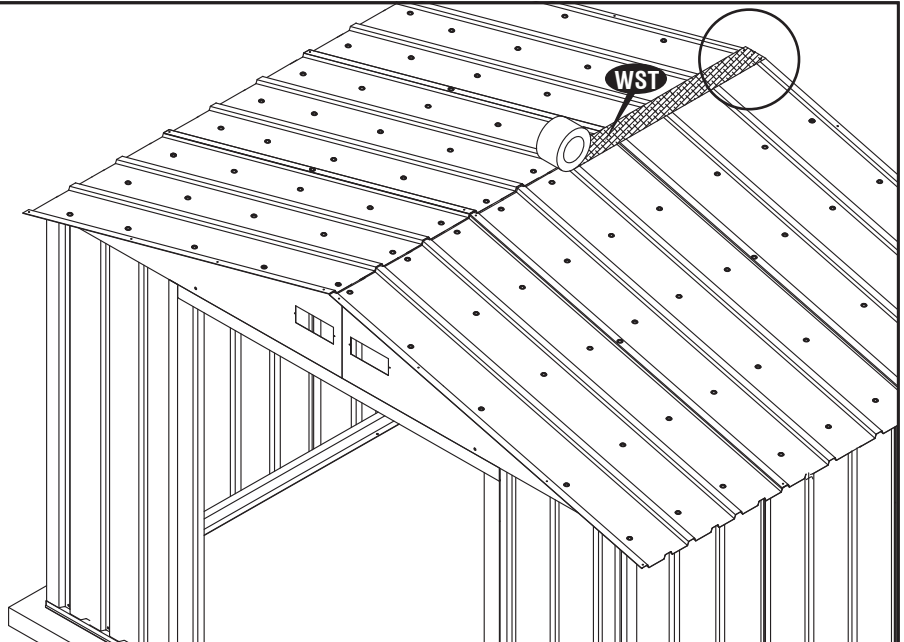
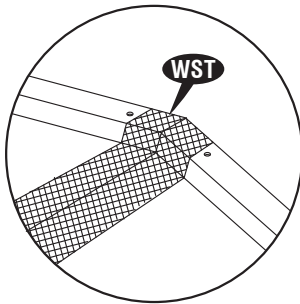

25

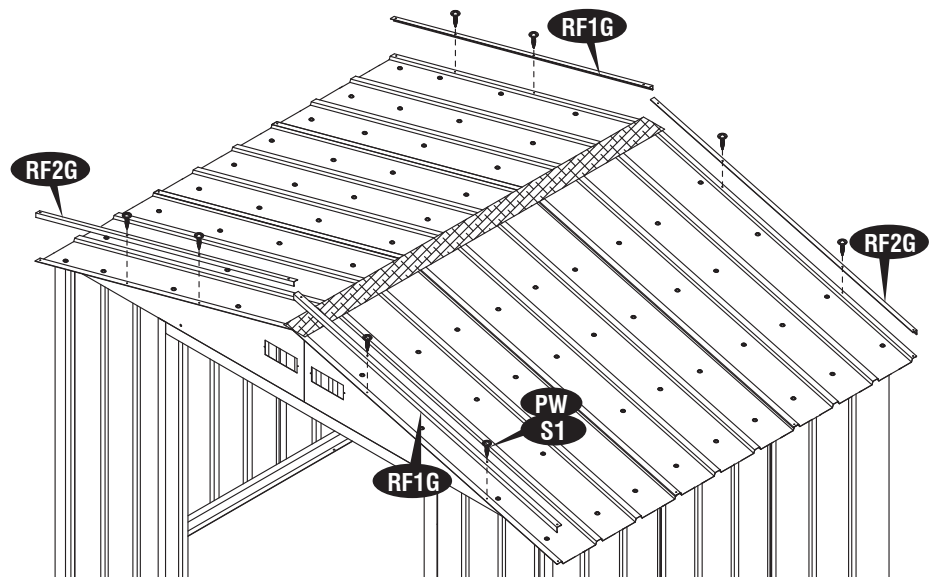

26

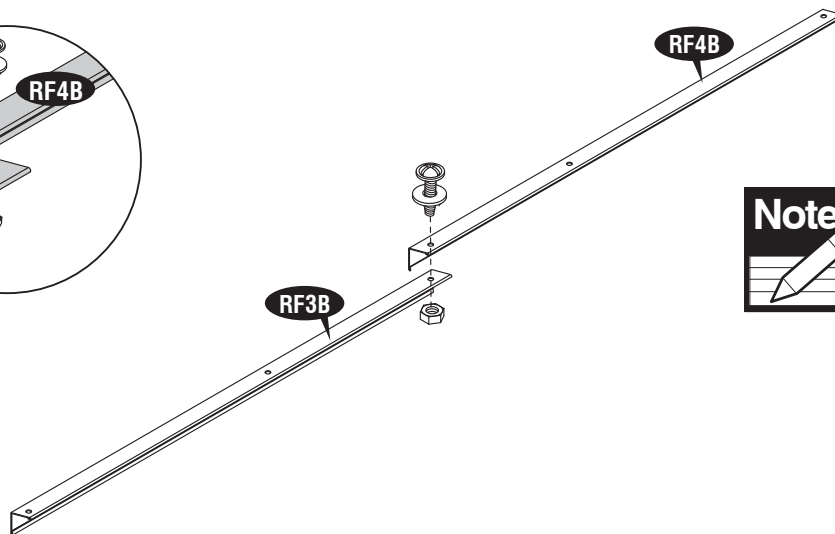
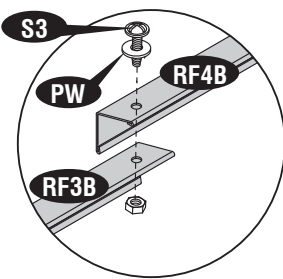

Note Make 2 sets.

27

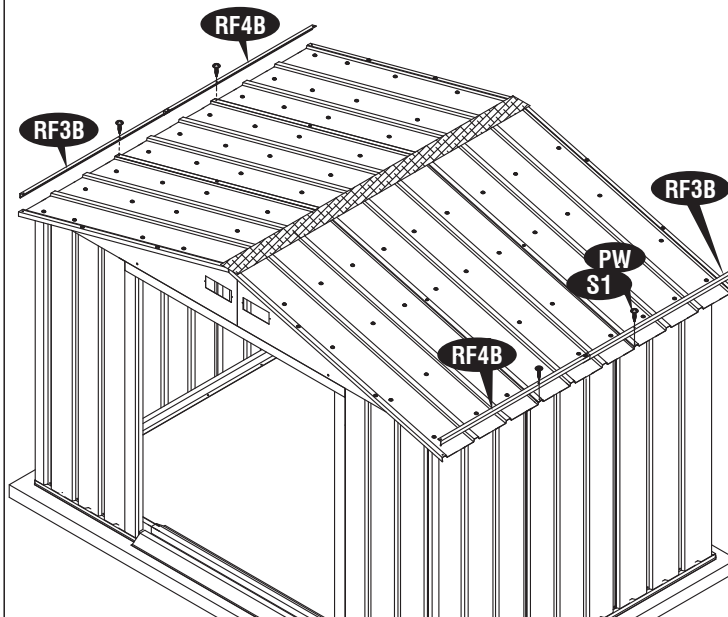

28

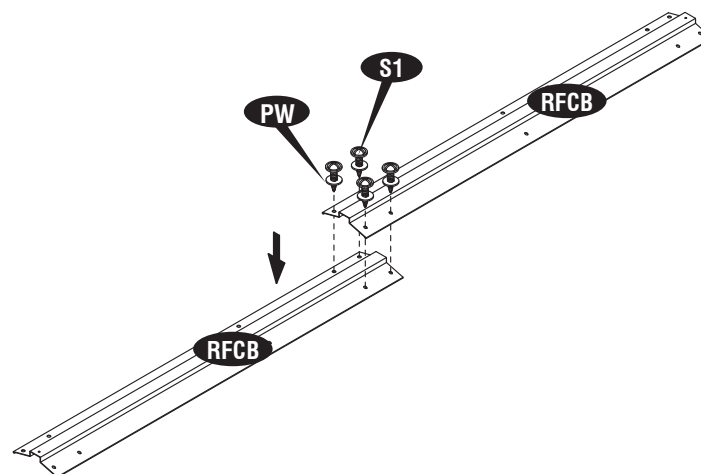

29

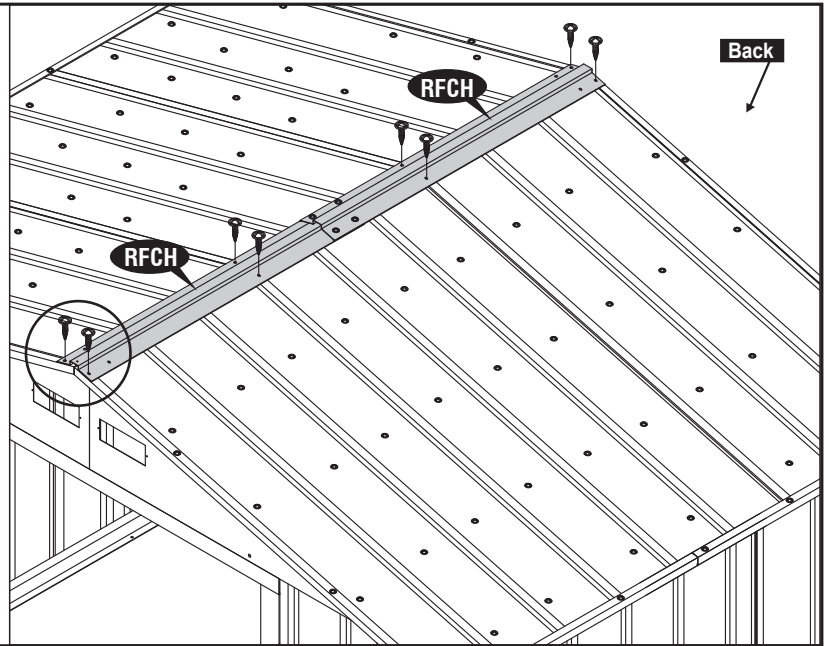
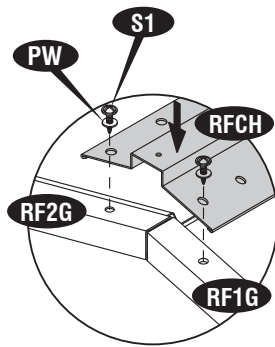

30

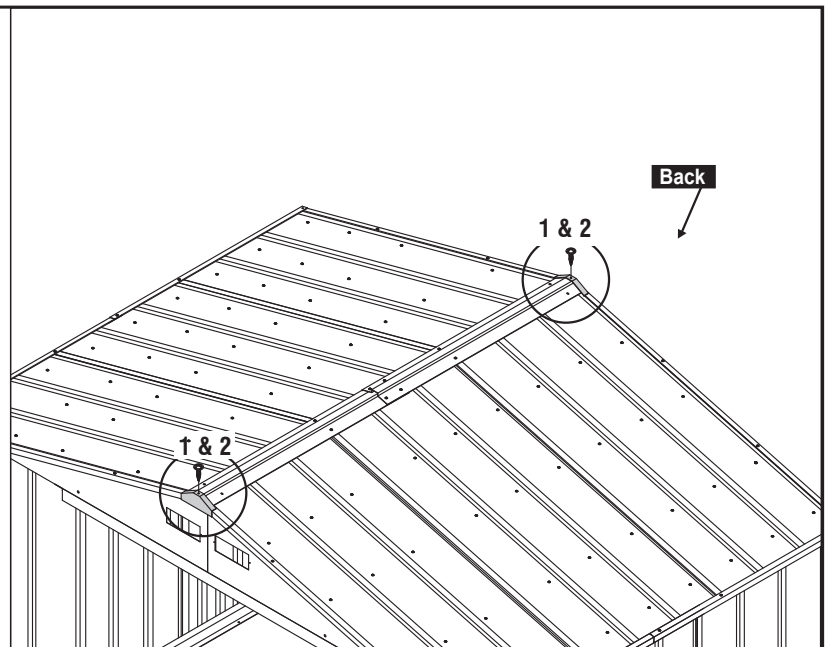
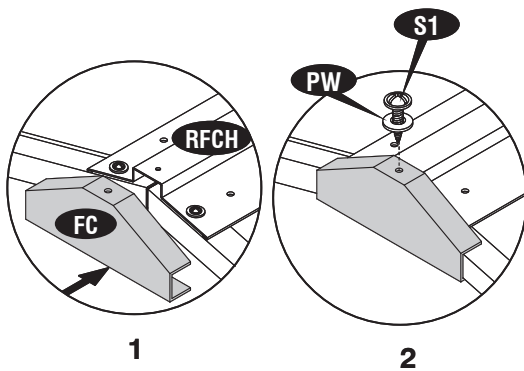

31

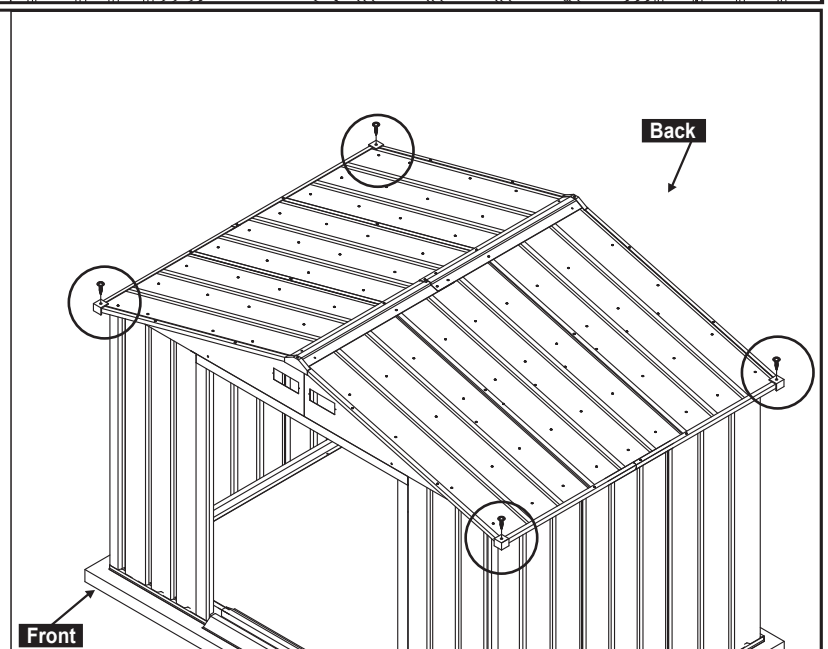
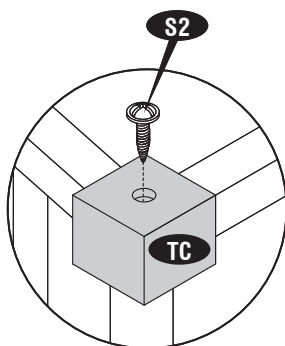

32

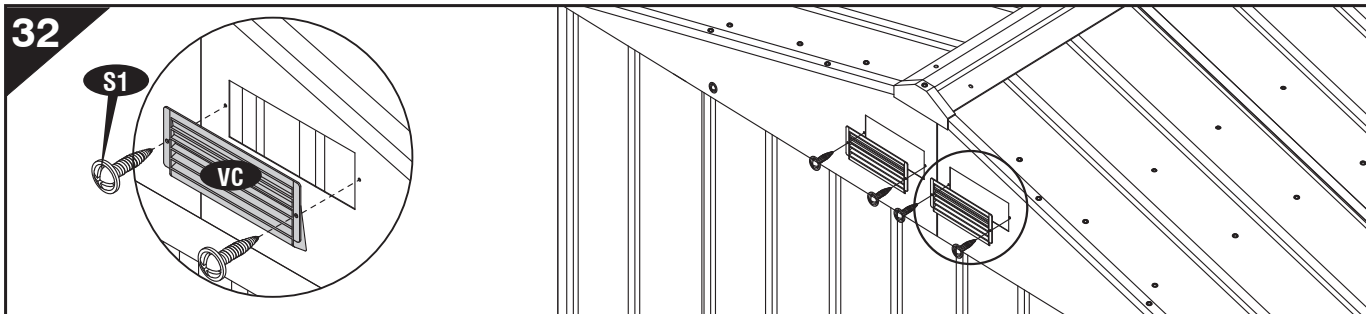

33

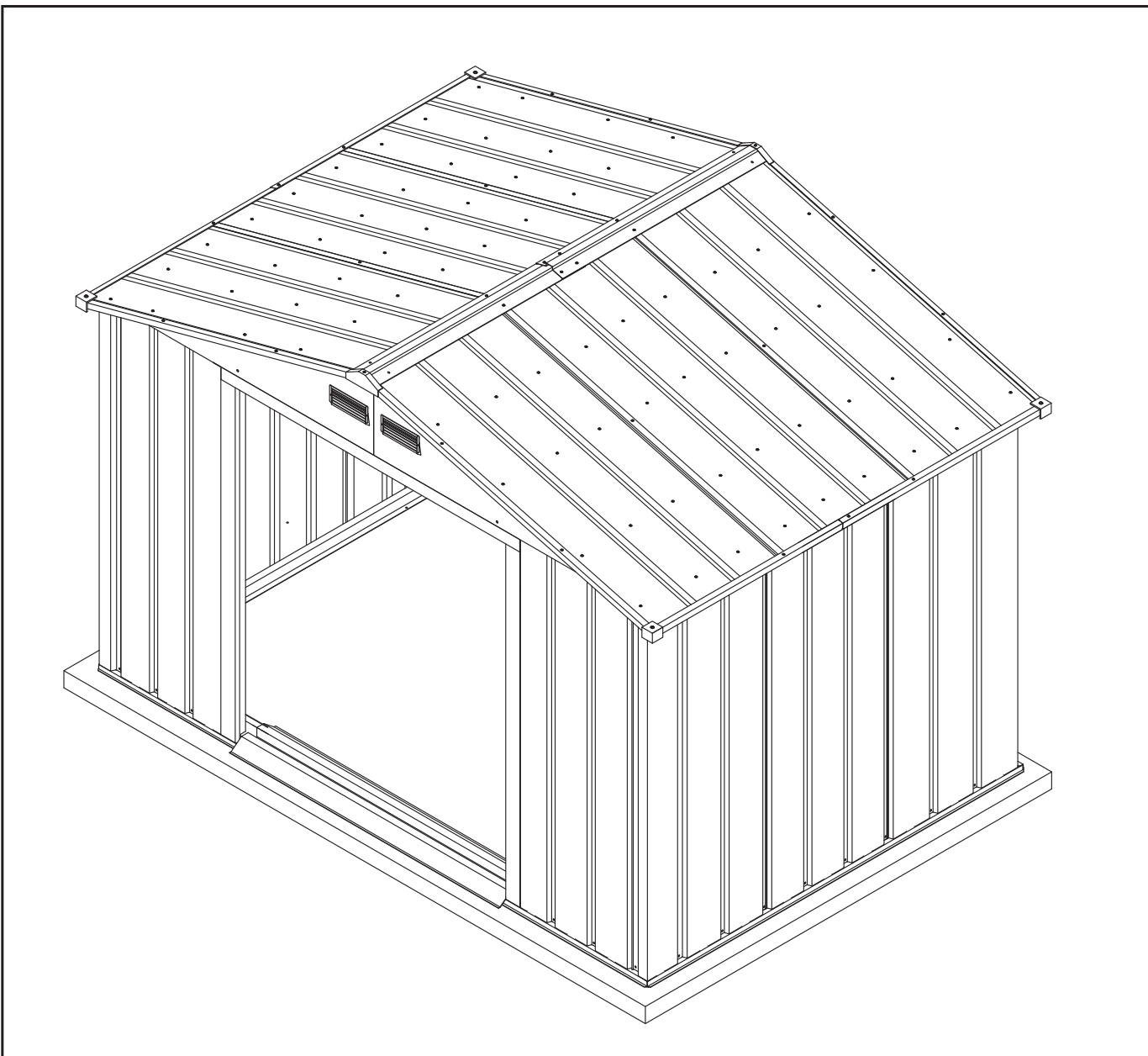
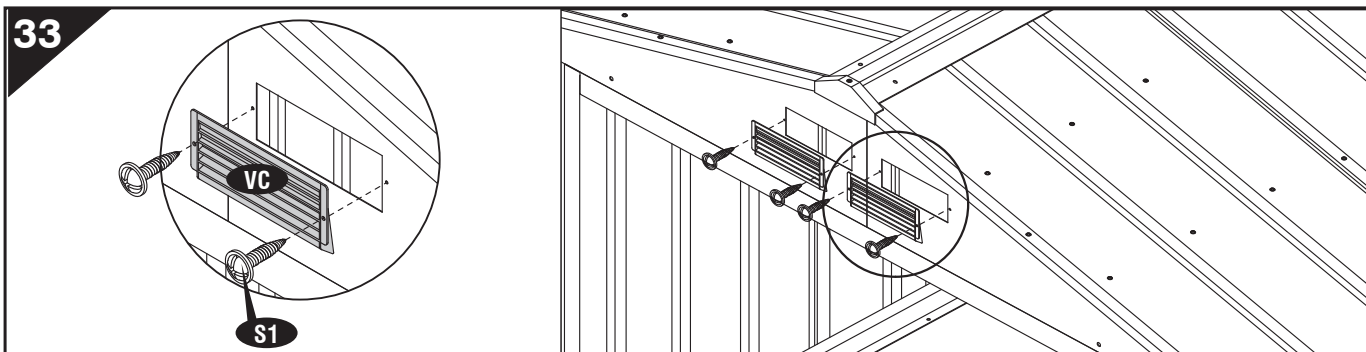

E. Door

IMPORTANT : *Use screws with plastic washers on top of prepainted surface only.*

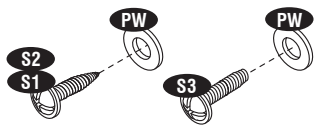

CODE	QTY	CODE	QTY
DPLB	1	BSLB	1
DPRB	1	BSRB	1
DSCB	4	DH	2
DSS	2	BS	4
TSLB	1	PW	22
TSRB	1	S1	14
		S3	26

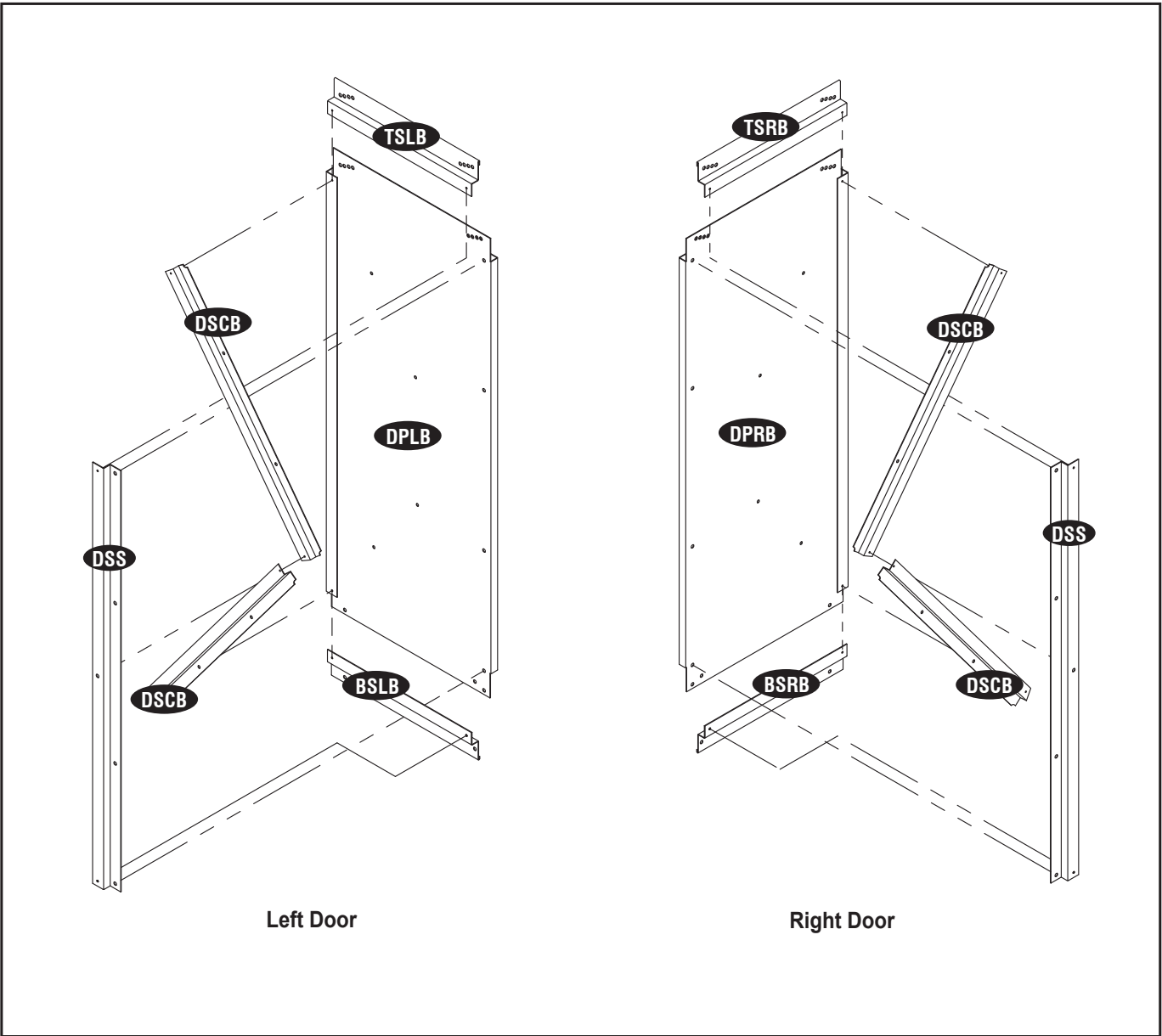

Right Door Assembly

1

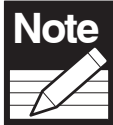
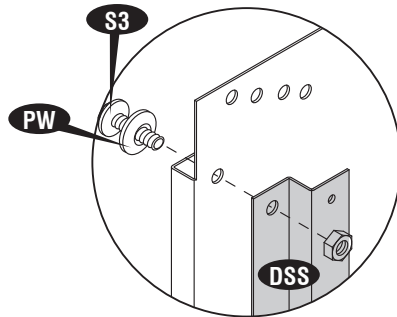

Note Remove the Polyethylene Film before assembling.

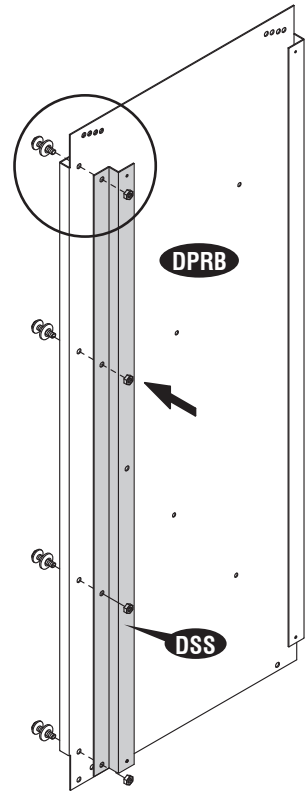

2

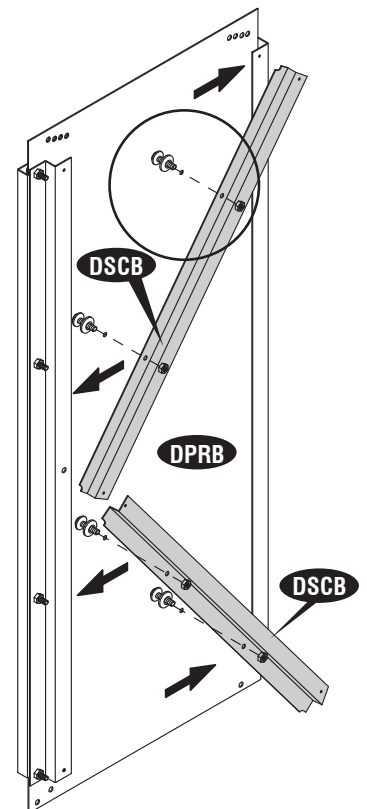
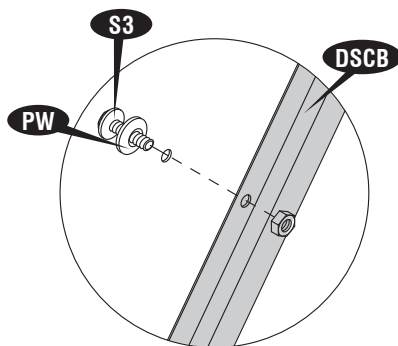

3

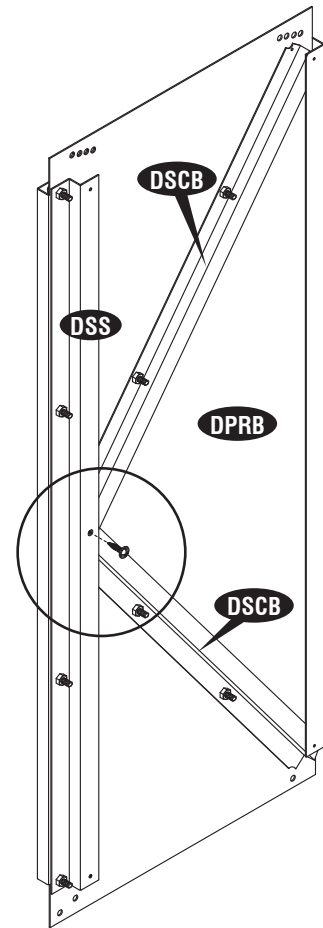
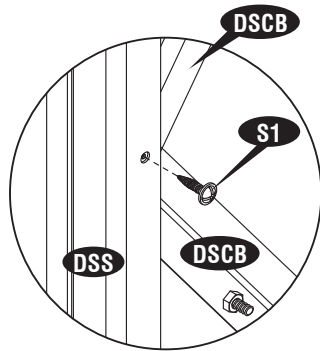

4

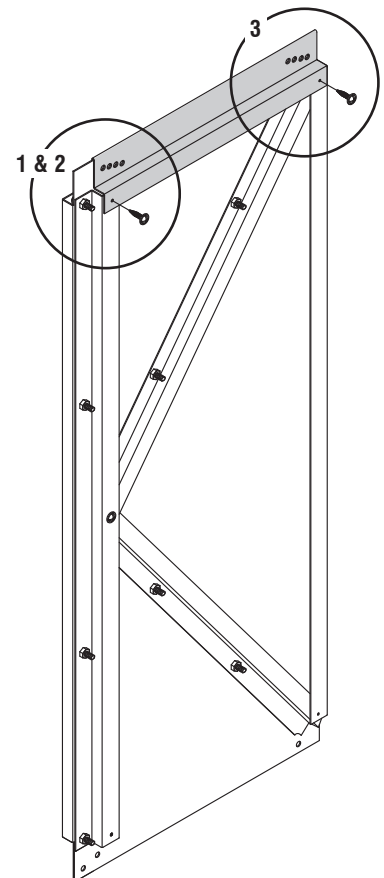
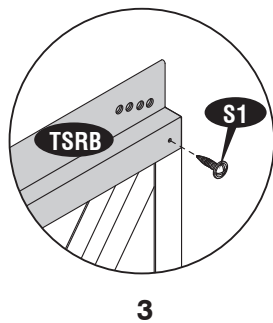
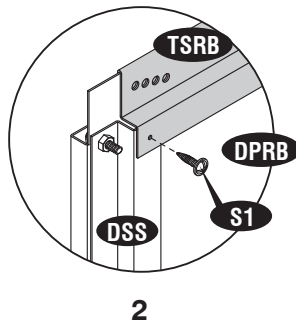
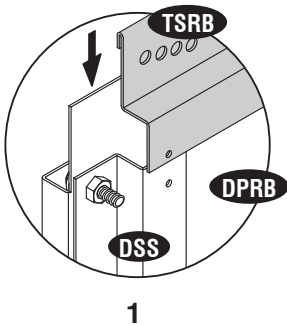

5

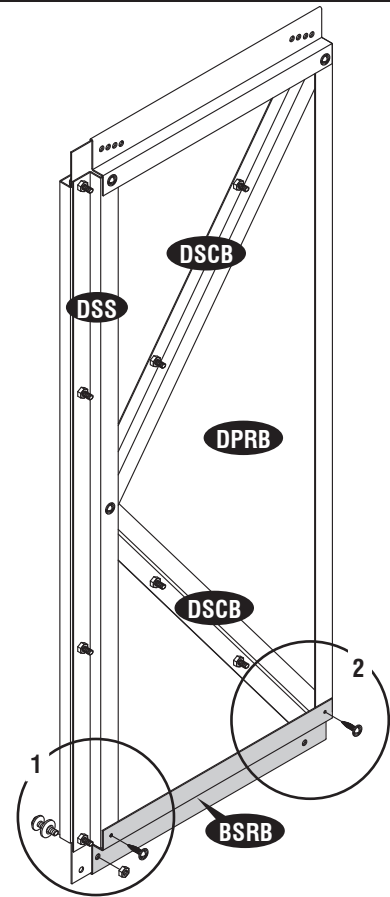
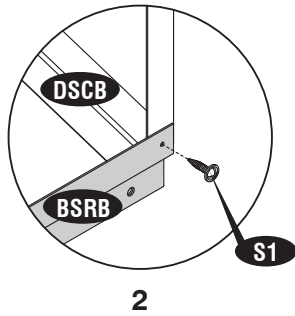
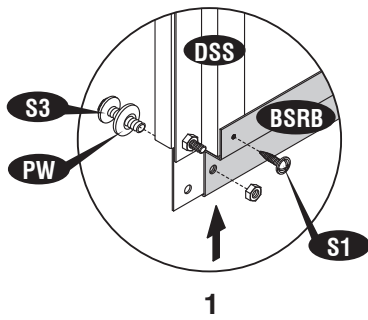

6

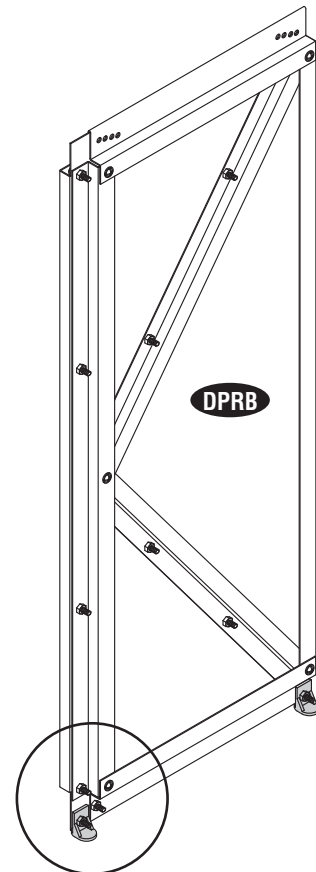
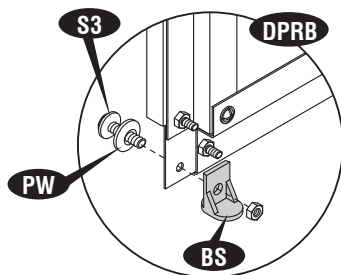

7

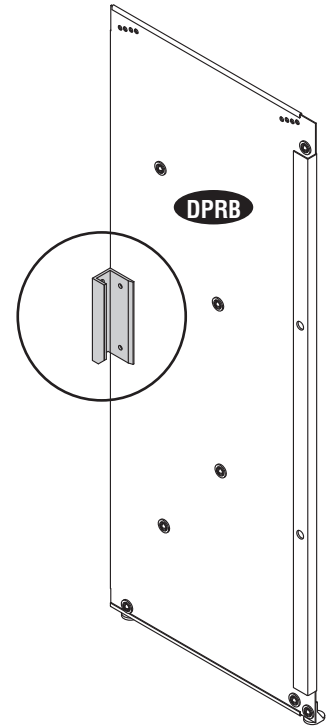
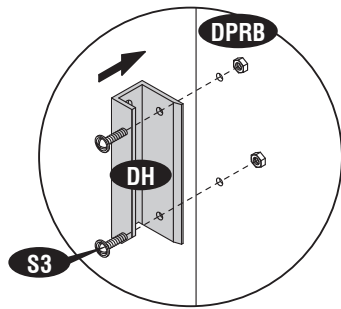

Left Door Assembly

1

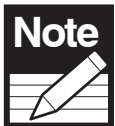
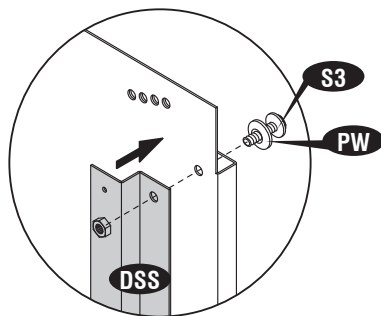

Note Remove the Polyethylene Film before assembling.

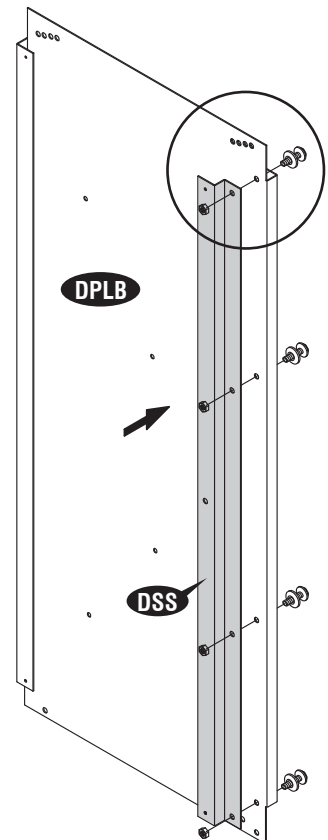

2

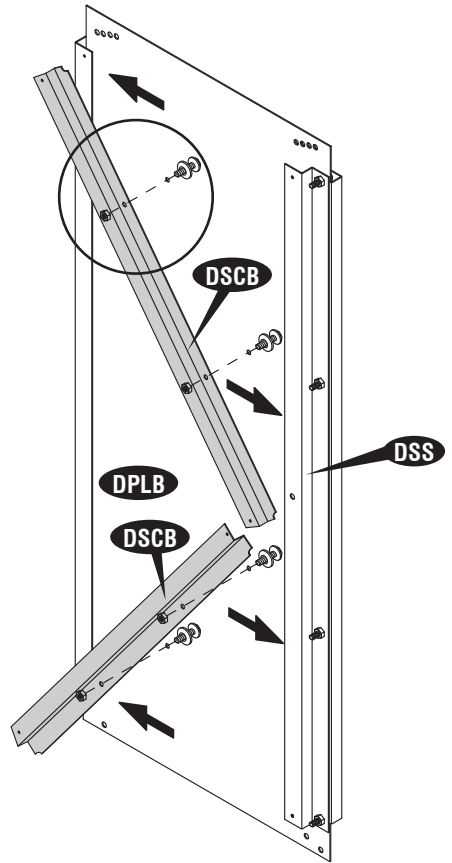
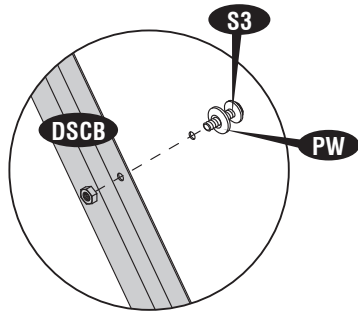

3

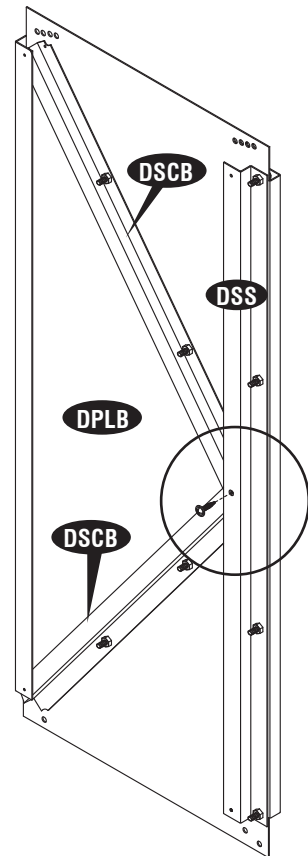
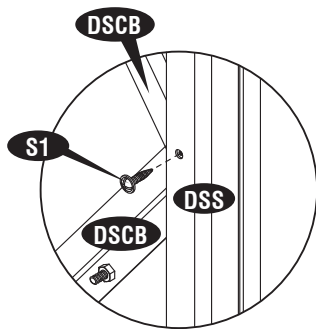

4

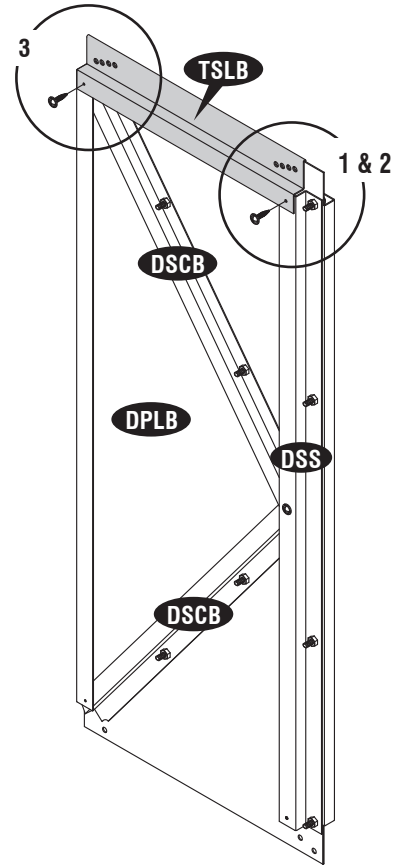
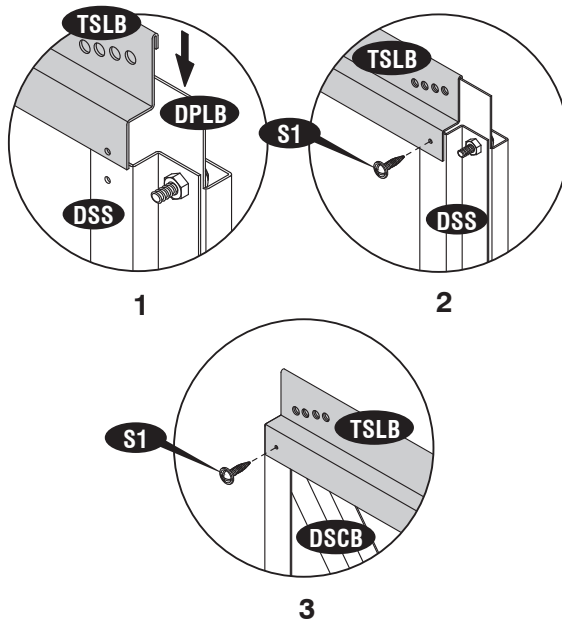

5

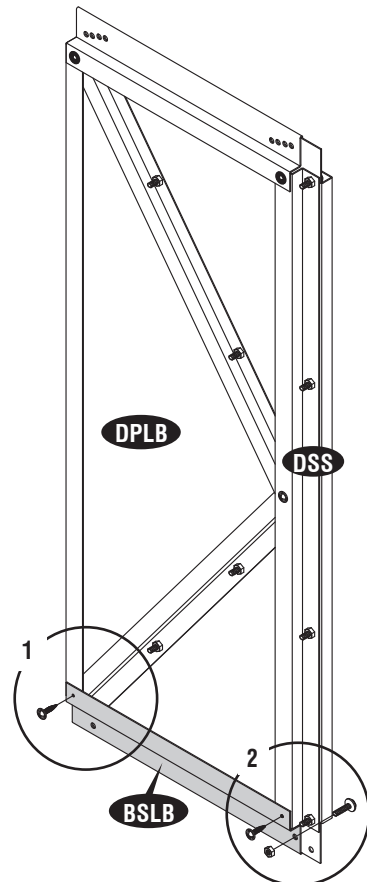
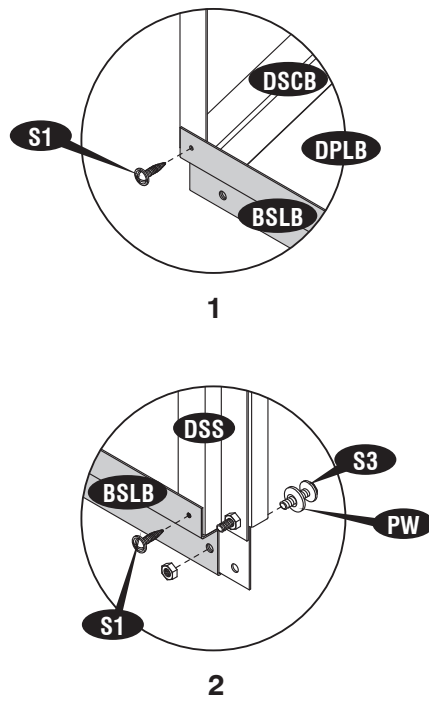

6

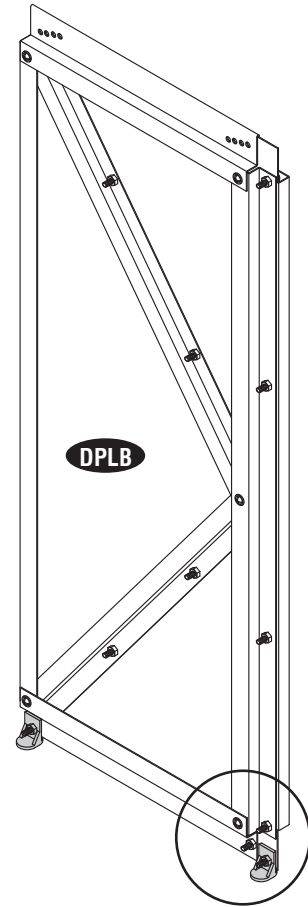
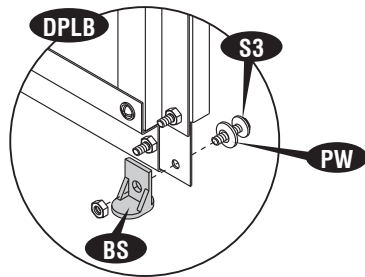

7

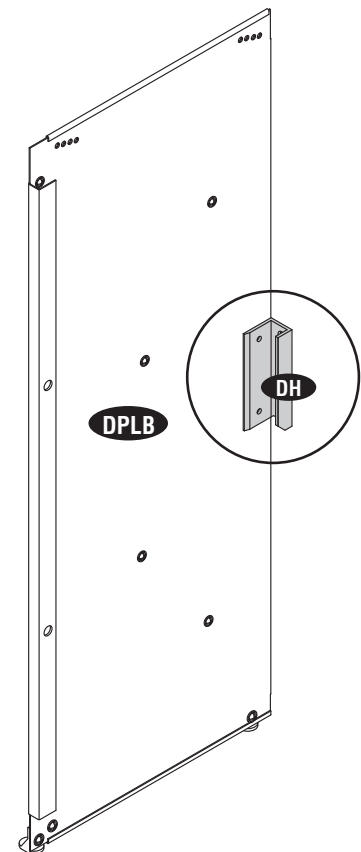
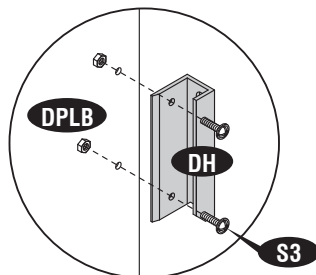

8

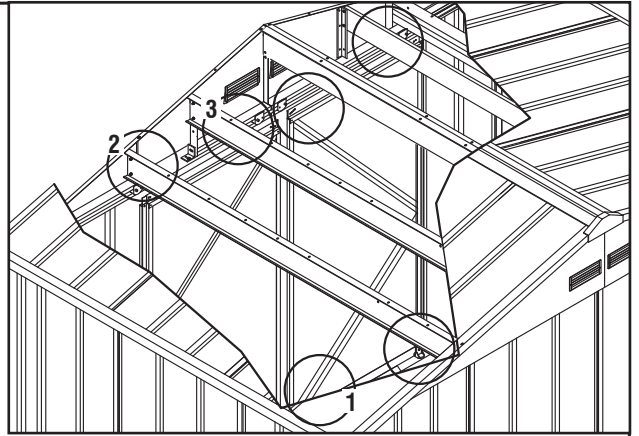
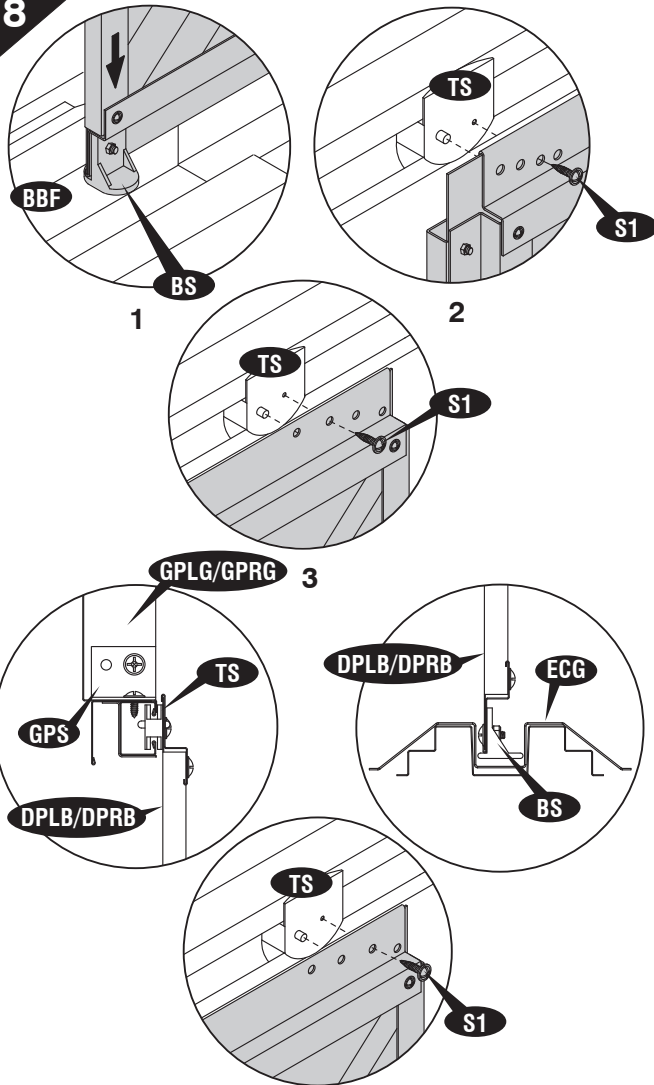
**Note**

To get proper alignment of the door realign the holes with door panel. See fig.

9

IMPORTANT

Fix the plastic screw cover (PC) to the screws and bolts edge from inside to prevent injury.

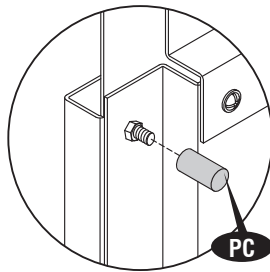
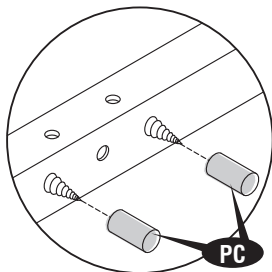

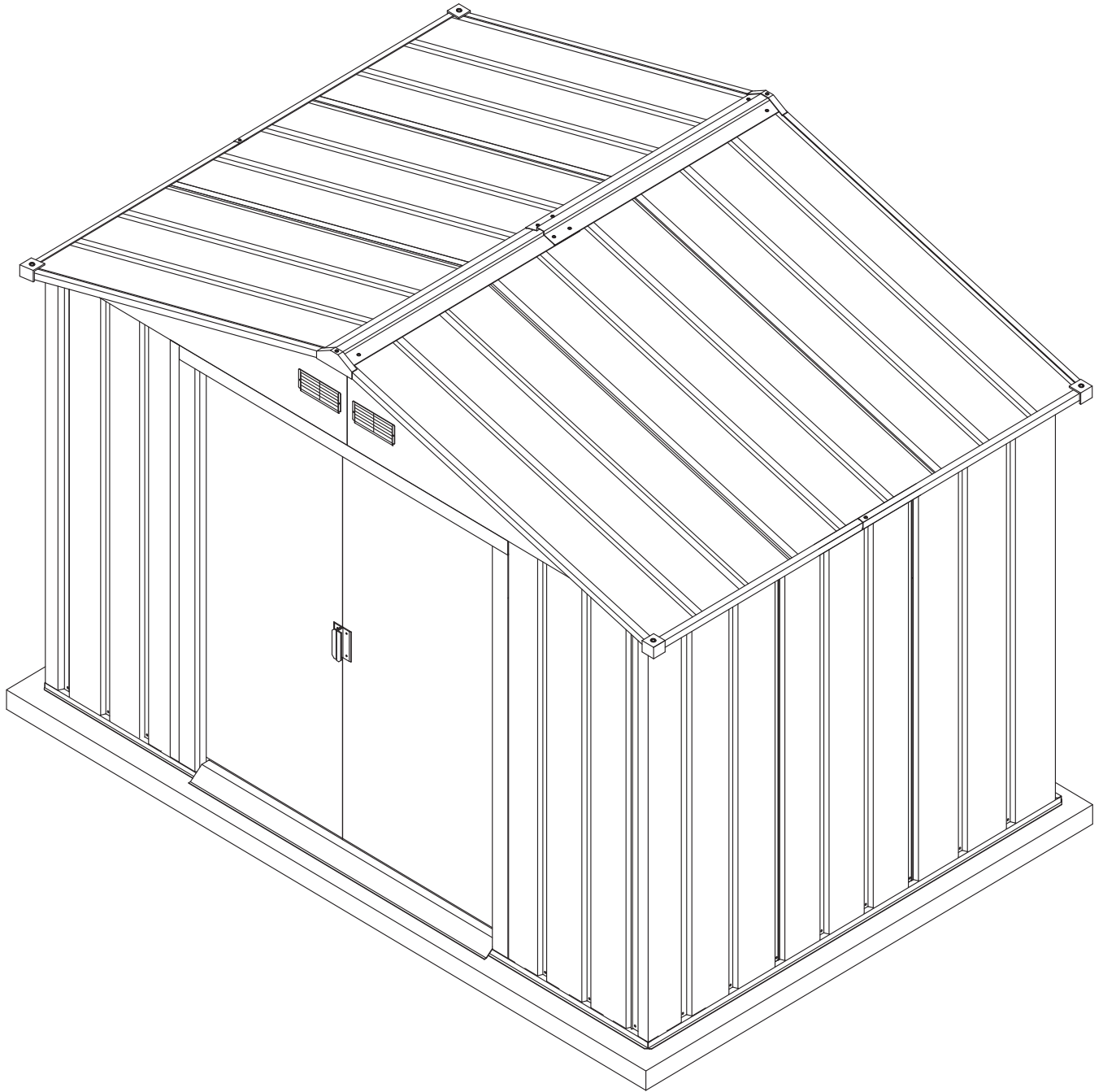

“We recommend to clear snow from the Roof top after each Snowfall.”

ADDITIONAL ACCESSORIES AVAILABLE

These accessories are required in case of heavy snow or high wind areas.
Please choose relevant accessories according to your needs.

ANCHOR KIT (Soil)

Wire rope with twist augers for sheds installed with foundation (Wood / Metal) on soil.
For heavy wind area.

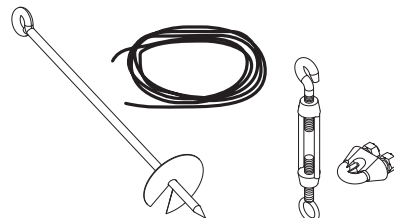

ANCHOR KIT (Concrete)

Eye bolt with wire rope for sheds installed with foundation (Wood / Metal) on concrete.
For heavy wind area.

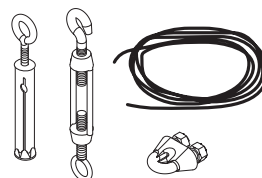

ANCHOR KIT (Foundation)

Strap clamping for shed assembly with foundation (Wood / Metal) on concrete.
To prevent shed from displacement.

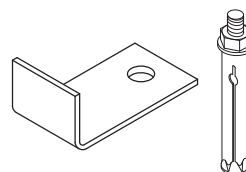



U.S. Polymers, Inc.
1057 S. Vail Ave
Montebello, CA 90640,
United States of America